



# GC16 series instruction manual

**WARNING !!**

- This product is suggested for users 18 years or older.
- Wear goggles while shooting.
- Incorrect use may cause injury or death.
- Never point at humans and animals with the airsoft guns.
- Read the whole manual before using.
- Buyers and users should obey the laws and rules of the local authority.

**CAUTION**  
Keep the selector on Safe mode until you are actually ready to shoot.

## REAR SIGHT ADJUSTMENT

**Windage adjustment knob**    **Elevation adjustment knob**

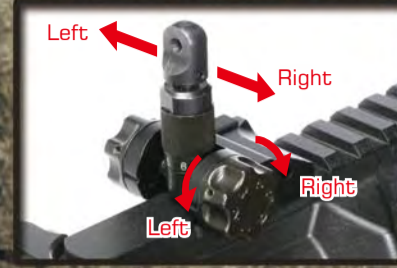

For rear sight left-right adjustment. Turning clockwise. Turning counter-clockwise more the pellet hitting to the right.



For rear sight up-down. Turning clockwise: Raise the pellet hitting point. Turning counter-clockwise: Lower the pellet hitting point.



**SPECIAL SHOOTING**  
Used for precision firing.



**COMMON SHOOTING**  
Used for full automatic firing.



**WINDAGE KNOB** (left / right adjustment)  
**ELEVATION KNOB** (up / down adjustment)

## RETRACTABLE STOCK

## MOVABLE PARTS

## MAINTENANCE

## RETRACTABLE STOCK

## MOVABLE PARTS

## TROUBLE SHOOTING



Press the stock release lever to unlock.



Adjust the position ( 6 position ).

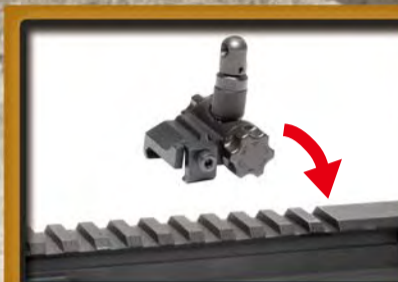

Detachable rear sight.



Unscrew the screw to disassemble the rear sight.



Take off the rear sight to install other accessories.

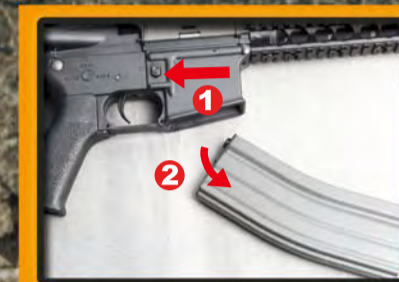

Remove the magazine.

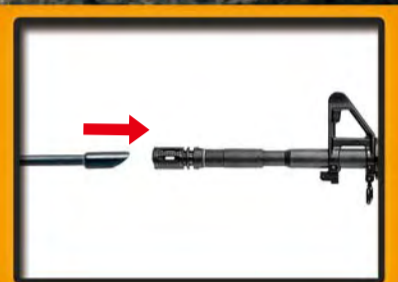

Return the hop up dial to normal position and insert the cleaning rod from the lead edge of the inner barrel.



Be aware to have the rod facing down and reaching to the end, and remove clogged pellets.



Press the stock release lever to unlock.



Adjust the position ( 6 position ).



Detachable the carrying handle

Turn the knobs counterclockwise.



Take off carrying handle.



Dot sight (Optional)

You can buy other accessories to install on the rail system.



Adjust screw when the gear noise becomes shrilly.

The screw at bottom of the grip. Please use the screwdriver to adjust.



No operation

Check the wire set contact with motor.



No operation

Check the battery and connector.

## PARTS LIST

- |         |                                |         |                           |
|---------|--------------------------------|---------|---------------------------|
| GC16-01 | Flash suppressor set           | GC16-17 | Magazine catch set        |
| GC16-02 | Rail system set                | GC16-18 | Selector lever set        |
| GC16-03 | Rear sight base set            | GC16-19 | Stock washer              |
| GC16-04 | Rear sight set                 | GC16-20 | Enhanced rod set          |
| GC16-05 | Front barrel / Front sight set | GC16-21 | Hi-cap 450R magazine      |
| GC16-07 | Barrel base set                | GC16-22 | Lower receiver set        |
| GC16-08 | Piston rod                     | GC16-23 | Trigger guard set         |
| GC16-09 | Assist knob set                | GC16-24 | Selector plate            |
| GC16-10 | Inner barrel                   | GC16-25 | Rear frame lock pin set   |
| GC16-11 | Upper receiver set             | GC16-26 | Grip                      |
| GC16-12 | Charging handle set            | GC16-27 | Motor set                 |
| GC16-13 | Hop-up set                     | GC16-28 | Motor cap                 |
| GC16-14 | Port cover set                 | GC16-29 | Extended stock set        |
| GC16-15 | Front frame lock pin set       | GC16-30 | Rear wire set             |
| GC16-16 | Bolt catch set                 | GC16-31 | Gear box set              |
| GC16-06 | Delta ring set                 | GC16-35 | Handguard set             |
| GC16-32 | Carrying handle set            | GC16-36 | Retractable stock set     |
| GC16-33 | Rear outer barrel set          | GC16-37 | Reinforced Grip for T4-18 |
| GC16-34 | Front outer barrel set         |         |                           |

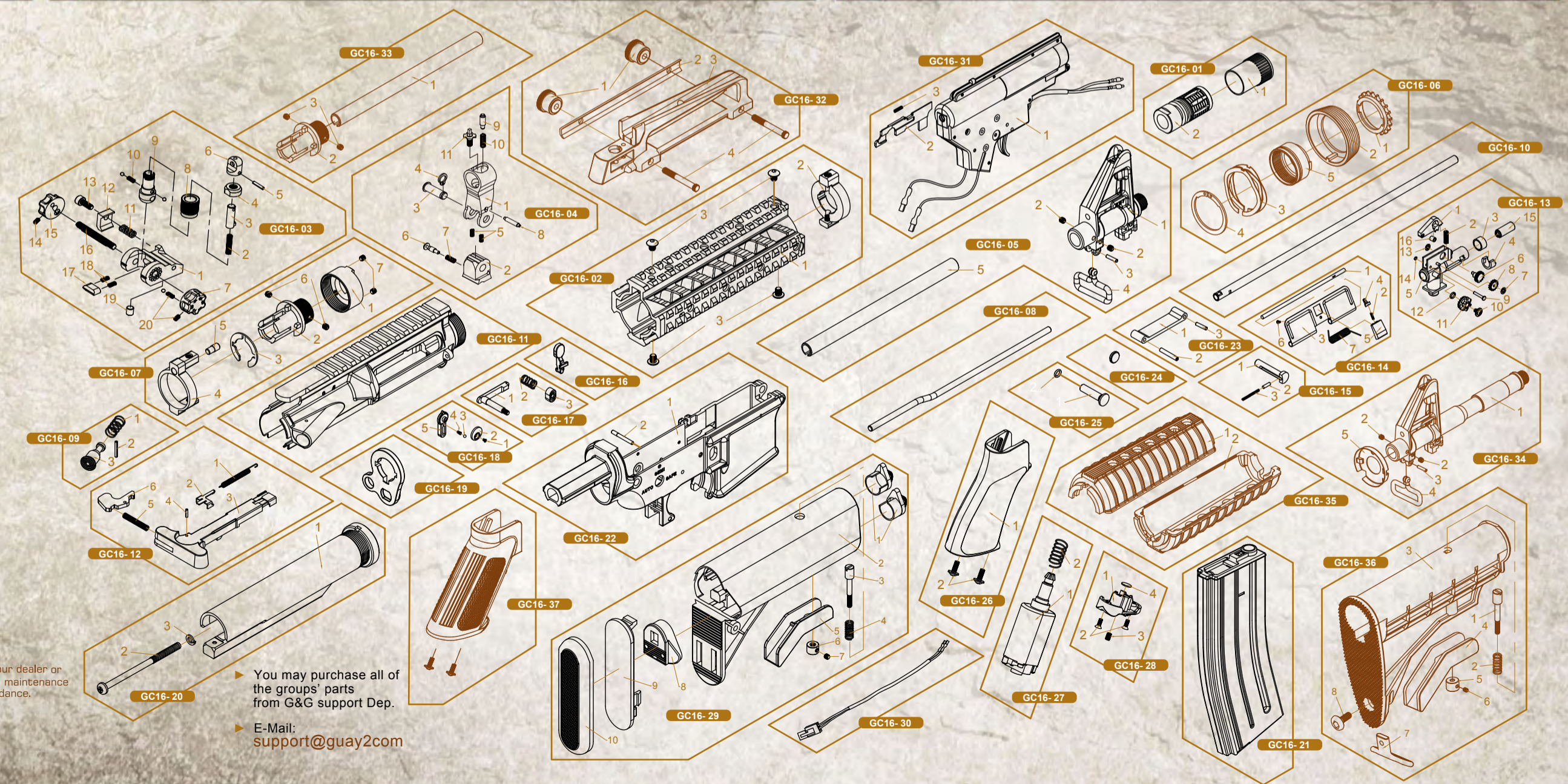

## G&G ARMAMENT

ADDRESS **Changhua** / No. 999, Zhonghua Rd., Shengang Township, Changhua County 50952, Taiwan  
**(Head Quarter)**  
**Taipei** / 11F-3, NO.27, Lane 169, Kangning St, Shijr City, Taipei County 22180, TAIWAN

E-Mail **Sales Department** / sales@guay2.com  
b2b@guay2.com

**Technology support Department** / support@guay2.com

WEBSITE [www.GUAY2.com](http://www.GUAY2.com)

TEL **Changhua** / 886-4-798-9000  
**Taipei** / 886-2-2692-2000

FAX **Changhua** / 886-4-798-9900  
**Taipei** / 886-2-2692-4000



Please consult your dealer or G&G for overhaul maintenance and technical guidance.

You may purchase all of the groups' parts from G&G support Dep.

E-Mail: support@guay2.com