

FF15-L.16.26 Blow Back INSTRUCTION MANUAL

⚠ WARNING !!

- Adult supervision required.
- Always wear safety goggles when using this product.
- Misuse or careless handling of this product may cause injury.
- May be hazardous up to 50 meters.
- This product is intended for users 18 years or older.
- Read all instructions before using this product.
- The buyer and the user of this product shall adhere to all local laws regulating the usage and the ownership of airsoft guns.

FIRING MODE & SAFETY



SAFETY ON
The trigger cannot be pulled



SEMI AUTO
Single shot



FULL AUTO
Automatic firing

BATTERY SETTING

FF15-L BATTERY SETTING

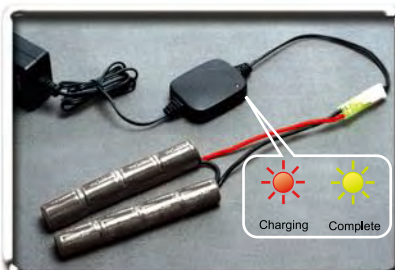

1. Charge up the battery.
2. Charging will be completed after 3 hours.

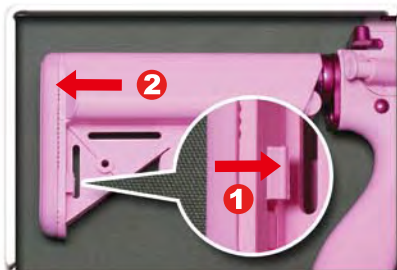

1. Push the butt plate lock (both sides)
2. Pull out the butt plate.



Take off the cover.

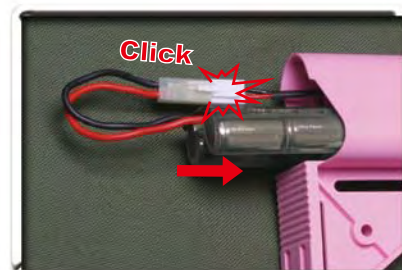

Connect battery plug with the connector.
Insert the battery and reinstall the cover.

FF16 BATTERY SETTING



1. Pull the slip ring and hold.
2. Disassemble the lower handguard.

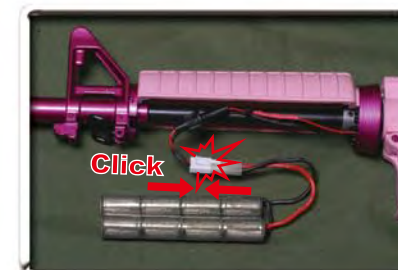

Connect battery plug with the connector.



1. Pull the slip ring and hold.
2. Reinstall the lower handguard.

⚠ CAUTION

1. Please select quality battery with the CE approval, to avoid any unnecessary damage on the product.
2. Please use either 8.4V or 9.6V battery, if different voltage used, it might damage the product.
3. Remove the battery from the product when it is not in use.
4. Do not wet nor incinerate the battery, nor to deform the terminal.

FF26 BATTERY SETTING



1. Pull the slip ring and hold.
2. Disassemble the lower handguard.



Connect battery plug with the connector.

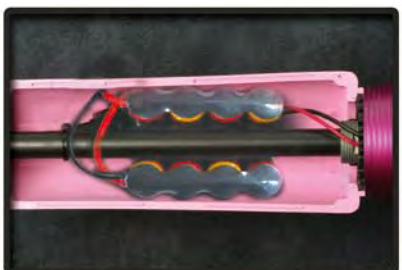

Insert the battery and reinstall the cover.

HOP-UP ADJUSTMENT

⚠ CAUTION

Do not catch your fingers in the dummy bolt.
Never hold the gun sideways as the BB pellets will curve right or left.



Turn to Normal Turn to Hop

- Best Position. ☒
- Too much Hop-up.
☒ (Turn the adjust lever toward Normal)
- Not enough Hop-up.(Turn the adjust lever toward Hop)
or Too much Hop-up.(Turn the adjust lever toward Normal)



AEG Blow Back System

In order to simulate the bolt action of a real firearm, G&G is proud to present its new Pneumatic Blow Back system to its line of airsoft guns. Conventional airsoft blow back utilizes tow hook springs that connect to the piston head and bolt plate to simulate bolt action, which often lead to excess wear and tear and poor reliability in the gear box. To alleviate the problem of conventional systems, G&G has independently developed the Pneumatic Blow Back system for a better solution on simulating bolt actions. This new technology utilizes compressed air to move the bolt, which enables the action without adding extra stress to the gear box. This class leading system represents a significant milestone in the airsoft industry.



TAIWAN
Patent No : M300797



USA
Patent No : 11/488698



HONG KONG
Patent No : 06107627.0



JAPAN
Patent No : 實願2006-1459



EUROPEAN UNION
Patent No : 460191 814454



CHINA
Patent No : 200620122468.9



DENMARK
Patent No : BA2007 0069



U.K.
Patent No : 614422.4

MAGAZINE SETTING

CAUTION

It is strongly recommended the use of G&G BB pellets only. Using low quality BB pellets will shorten product life span and void product warranty.



Open the cover of magazine.

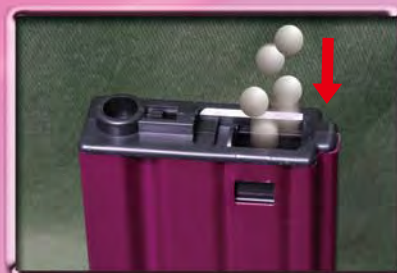

Load G&G 5.95mm BB pellets into the magazine.



Close the cover plate then turn the gear until the sound changes.



Insert the magazine until you heard a click sound.

REAR SIGHT ADJUSTMENT

CAUTION

Keep the selector on Safe mode until you are actually ready to shoot.



SPECIAL SHOOTING
Used for precision firing.



COMMON SHOOTING
Used for full automatic firing.

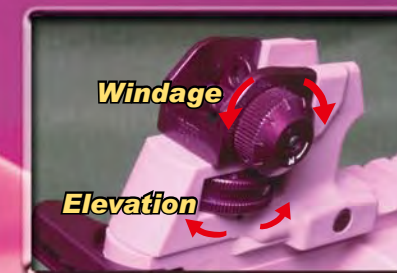

WINDAGE KNOB (left / right adjustment)
ELEVATION KNOB (up / down adjustment)

MOVABLE PARTS



Detachable rear sight.



Detachable carrying handle.



Turn the knobs counterclockwise to disassemble.

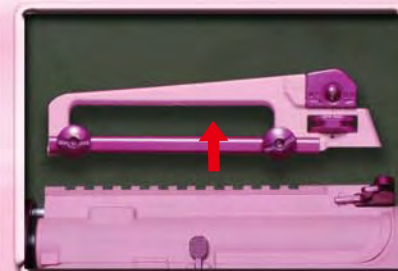

Take off the carrying handle or rear sight to install other accessories.

MAINTENANCE

CAUTION

- Make sure no dirt gets into the chamber to avoid clogging of pellets.
- Hop-up may be unstable for 200 to 300 rounds after using silicone oil. This is the normal operation of the gun.
- Never use CRC-556, WD40, or other corrosive lubricants.



Remove the magazine.



Return the hop up dial to normal position and insert the cleaning rod from the lead edge of the inner barrel.

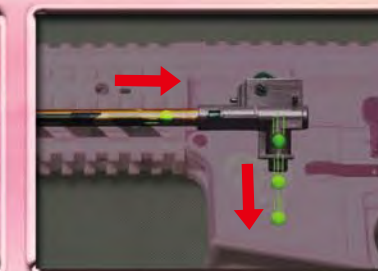

Be aware to have the rod facing down and reaching to the end, and remove clogged pellets.

RETRACTABLE STOCK



Press the stock release lever to unlock. Adjust the position (6 position).



Press the stock release lever to unlock. Adjust the position (6 position).



Press the stock release lever to unlock. Adjust the position (6 position).



► G-03-065-2
Forward Grip (ABS Injection)

TROUBLE SHOOTING

CAUTION

- Use only the G&G battery purchased from your local dealer.



The screw at bottom of the grip. Please use the screwdriver to adjust.



Check the wire set contact with motor.

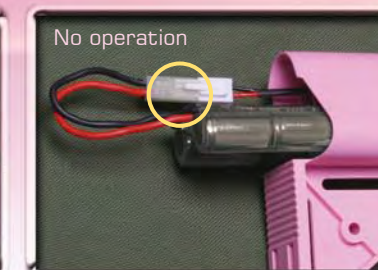

Check the battery and connector.

PARTS LIST

For FF15-L / FF16 / FF26

- FF15 BB - 01 Flash Suppressor Set
- FF15 BB - 04 Rear Sight Set
- FF15 BB - 08 Piston Rod
- FF15 BB - 09 Assist Knob Set
- FF15 BB - 10 Inner Barrel
- FF15 BB - 11 Upper Receiver Set
- FF15 BB - 12 Charging Handle Set
- FF15 BB - 13 Hop-Up Set
- FF15 BB - 14 Port Cover Set
- FF15 BB - 15 Front Frame Lock Pin Set
- FF15 BB - 16 Bolt Catch Set
- FF15 BB - 17 Magazine Catch Set
- FF15 BB - 18 Selector Lever Set
- FF15 BB - 19 Stock Washer

- FF15 BB - 22 Lower Receiver Set
- FF15 BB - 23 Trigger Guard Set
- FF15 BB - 24 Selector Plate
- FF15 BB - 25 Rear Frame Lock Pin Set
- FF15 BB - 26 Grip
- FF15 BB - 27 Motor Set
- FF15 BB - 28 Grip Bottom Set
- FF15 BB - 29 Rear Wire Set
- FF15 BB - 30 Gear Box Set
- FF15 BB - 31 Blow Back Pneumatic Piston
- FF15 BB - 32 Charging Plate
- FF15 BB - 33 Selector Plate
- FF15 BB - 34 Charging Upper Cover
- FF15 BB - 36 Outer Barrel

For FF15-L / FF16

- FF15 BB - 05 Front Sight / Barrel Set
- FF15 BB - 21 Hi-Cap 450R Magazine

For FF15-L

- FF15 BB - 02 Rail System Set
- FF15 BB - 20 Crane Stock Set
- FF15 BB - 29 Enhanced Rod Set
- FF15 BB - 41 Rail Base Set

For FF16

- FF16 BB - 06 Slip Ring Set
- FF16 BB - 38 Handguard Set
- FF16 BB - 39 Retractable Stock Set
- FF16 BB - 40 Carrying Handle Set

For FF15-L / FF26

- FF15 BB - 03 Rear Sight Base Set
- FF15 BB - 07 Barrel Base Set

For FF16 / FF26

- FF16 BB - 37 Enhanced Rod Set

For FF26

- FF26 BB - 41 Flash Suppressor
- FF26 BB - 42 Front Outer Barrel
- FF26 BB - 43 Handguard Set
- FF26 BB - 44 Retractable Stock Set
- FF26 BB - 45 300R Magazine

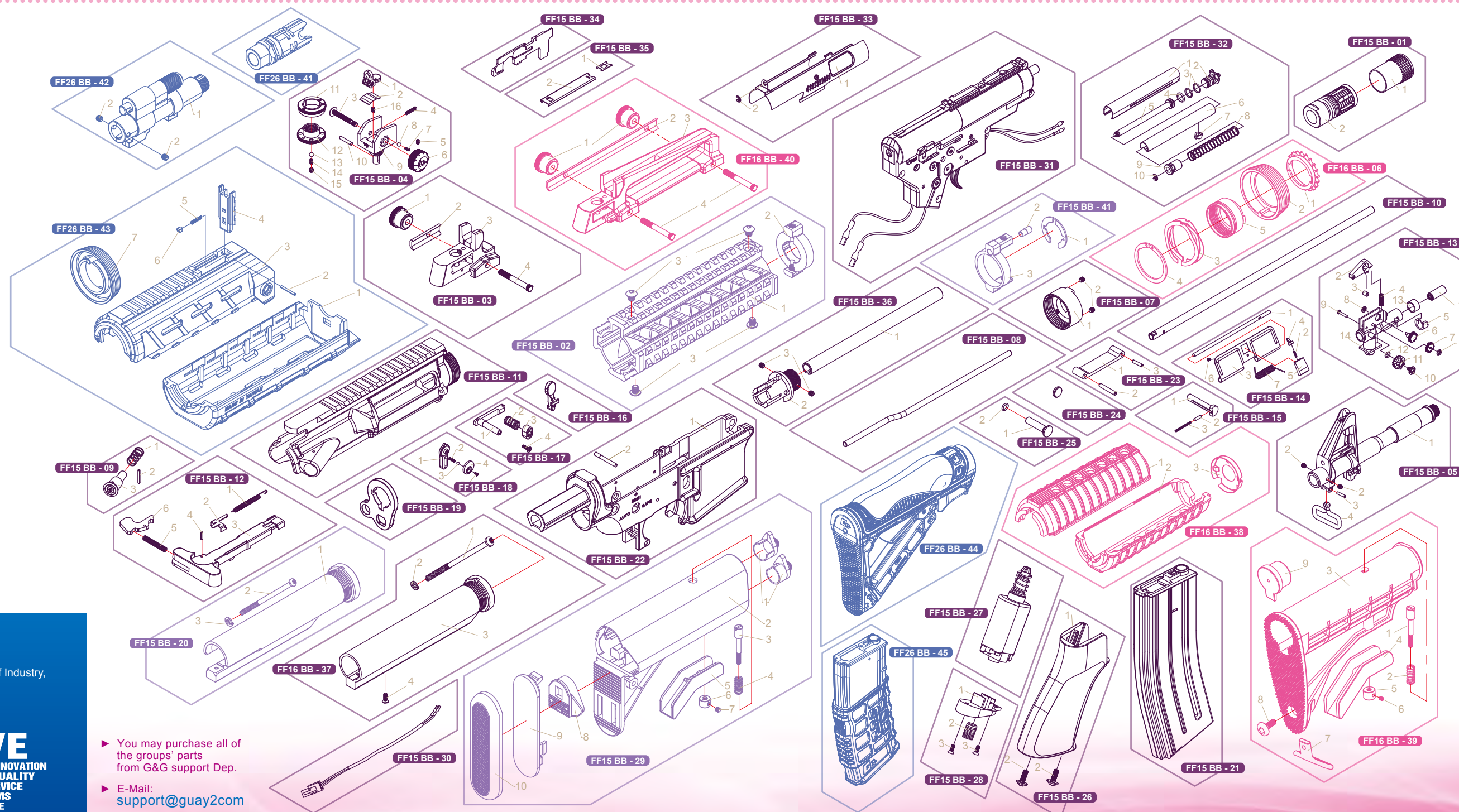

► You may purchase all of the groups' parts from G&G support Dep.

► E-Mail: support@guay2.com

TAIWAN

Changhua Tel : +886-4-798-9000 Fax : +886-4-798-9900
(Head Quarter) No.999, Zhonghua Rd. Shengang Township, Changhua County 50952, Taiwan (R.O.C.)
Taipei Tel : +886-2-2692-2000 Fax : +886-2-2692-4000
11F-3., No.27, Lane 169, Kangning St. Shijr City, Taipei County 22180, Taiwan (R.O.C.)

Sales Dept. sales@guay2.com, b2b@guay2.com
Technology Dept. support@guay2.com
PR Dept. pr@guay2.com

G2-201303-08-英

U.S.A.

Los Angeles Tel : +1-626-581-0101 Fax : +1-626-581-1011
1122 Colner Court City of Industry, CA91748 (U.S.A.)
sales101@guay2.com

