

GG16 series instruction manual



G&G ARMAMENT
AIRSOFT GUNS & ACCESSORIES

⚠ WARNING !!

- This product is suggested for users 18 years or older.
- Wear goggles while shooting.
- Incorrect use may cause injury or death.
- Never point at humans and animals with the airsoft guns.
- Read the whole manual before using.
- Buyers and users should obey the laws and rules of the local authority.

⚠ CAUTION

1. Please select quality battery with the CE approval, to avoid any unnecessary damage on the product.
2. Please use either 8.4V or 9.6V battery, if different voltage used, it might damage the product.
3. Remove the battery from the product when it is not in use.
4. Do not wet nor incinerate the battery, nor to deform the terminal.

FIRING MODE & SAFETY



Product appearance depends on actual goods



SAFETY ON
The trigger cannot be pulled



SEMI AUTO
Single shot



FULL AUTO
Automatic firing



Hi-Cap 450R Magazine

BATTERY SETTING



1. Charge up the battery.
2. Charging will be completed after 3 hours.



Pull out the butt plate from upper part.



Take out the battery stop.

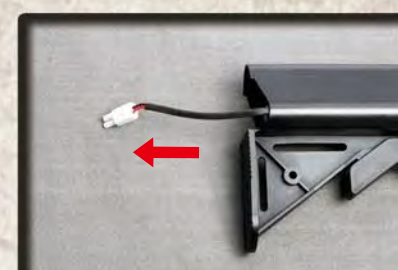

Pull out the wire connector.



Connect battery plug with the connector until you heard a click sound.

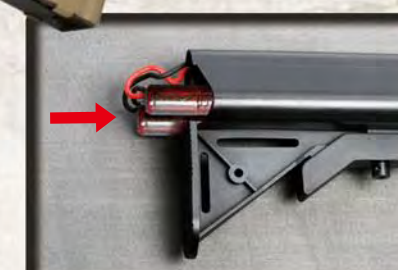

Insert the battery into stock.



Reinstall the battery cover and butt plate.



1. Pull the slip ring and hold.
2. Disassemble the lower handguard.



Connect battery plug with the connector.



1. Pull the slip ring and hold.
2. Reinstall the lower handguard.



Finish.

SETTING MAGAZINE

⚠ CAUTION

It is strongly recommended the use of G&G BB pellets only. Using low quality BB pellets will damage the product and void warranty.



Open the cover of magazine.



Load G&G 5.95mm BB pellets into the magazine.



Close the cover plate then turn the gear until the sound changes.



Insert the magazine until you heard a click sound.

HOP-UP ADJUSTMENT

⚠ CAUTION

Do not catch your fingers in the dummy bolt. Never hold the gun sideways as the BB pellets will curve right or left.



Turn to Normal Turn to Hop

- Too much Hop-up. (Turn the adjust lever toward Normal)
- Best Direction. O
- Not enough Hop-up. (Turn the adjust lever toward Hop) or Too much Hop-up. (Turn the adjust lever toward Normal)

WWW.GUAY2.COM Printed in Taiwan
Manufactured by G&G Armament





G&G ARMAMENT
AIRSOFT GUNS & ACCESSORIES

WWW.GUAY2.COM
Manufactured by G&G Armament
Printed in Taiwan

GC16 series instruction manual

WARNING !!

- This product is suggested for users 18 years or older.
- Wear goggles while shooting.
- Incorrect use may cause injury or death.
- Never point at humans and animals with the airsoft guns.
- Read the whole manual before using.
- Buyers and users should obey the laws and rules of the local authority.

REAR SIGHT ADJUSTMENT

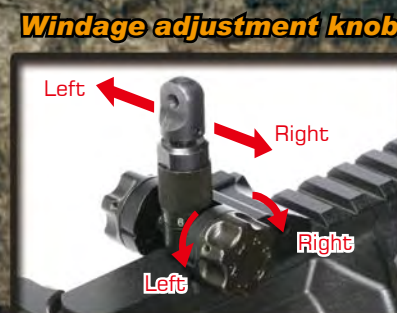

For rear sight left-right adjustment. Turning clockwise. Turning counter-clockwise more the pellet hitting to the right.



For rear sight up-down. Turning clockwise: Raise the pellet hitting point. Turning counter-clockwise: Lower the pellet hitting point.

RETRACTABLE STOCK

MOVABLE PARTS

MAINTENANCE

RETRACTABLE STOCK

MOVABLE PARTS

TROUBLE SHOOTING

SPECIAL SHOOTING

Used for precision firing.

COMMON SHOOTING

Used for full automatic firing.

WINDAGE KNOB (left / right adjustment)

ELEVATION KNOB (up / down adjustment)

CAUTION

Keep the selector on Safe mode until you are actually ready to shoot.



Press the stock release lever to unlock.



Adjust the position (6 position).

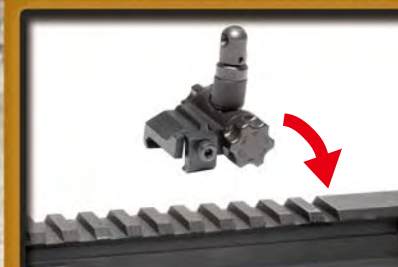

Detachable rear sight.



Unscrew the screw to disassemble the rear sight.

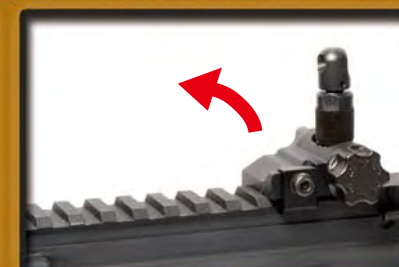

Take off the rear sight to install other accessories.



Remove the magazine.

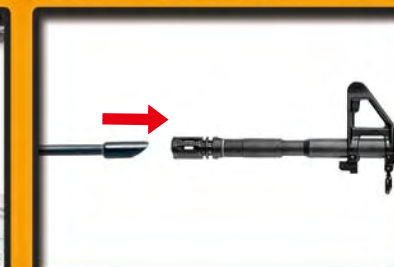

Return the hop up dial to normal position and insert the cleaning rod from the lead edge of the inner barrel.



Be aware to have the rod facing down and reaching to the end, and remove clogged pellets.



Press the stock release lever to unlock.



Adjust the position (6 position).



Detachable the carrying handle

Turn the knobs counterclockwise.



Take off carrying handle.



Dot sight (Optional)

You can buy other accessories to install on the rail system.



Adjust screw when the gear noise becomes shrilly.

The screw at bottom of the grip. Please use the screwdriver to adjust.



No operation

Check the wire set contact with motor.



No operation

Check the battery and connector.

PARTS LIST

- GC16-01** Flash suppressor set
GC16-02 Rail system set
GC16-03 Rear sight base set
GC16-04 Rear sight set
GC16-05 Front barrel / Front sight set
GC16-07 Barrel base set
GC16-08 Piston rod
GC16-09 Assist knob set
GC16-10 Inner barrel
GC16-11 Upper receiver set
GC16-12 Charging handle set
GC16-13 Hop-up set
GC16-14 Port cover set
GC16-15 Front frame lock pin set
GC16-16 Bolt catch set

- GC16-06** Delta ring set
GC16-32 Carrying handle set
GC16-33 Rear outer barrel set
GC16-34 Front outer barrel set

- GC16-17** Magazine catch set
GC16-18 Selector lever set
GC16-19 Stock washer
GC16-20 Enhanced rod set
GC16-21 Hi-cap 450R magazine
GC16-22 Lower receiver set
GC16-23 Trigger guard set
GC16-24 Selector plate
GC16-25 Rear frame lock pin set
GC16-26 Grip
GC16-27 Motor set
GC16-28 Motor cap
GC16-29 Extended stock set
GC16-30 Rear wire set
GC16-31 Gear box set

- GC16-35** Handguard set
GC16-36 Retractable stock set
GC16-37 Reinforced Grip for T4-18

G&G ARMAMENT

ADDRESS **Changhua** / No. 999, Zhonghua Rd., Shengang Township,
(Head Quarter) Changhua County 50952, Taiwan
Taipei / 11F-3, NO.27, Lane 169, Kangning St, Shijr City,
Taipei County 22180, TAIWAN

E-Mail **Sales Department**/ sales@guay2.com
b2b@guay2.com

Technology support Department/ support@guay2.com

WEBSITE WWW.GUAY2.COM

TEL **Changhua**/ 886-4-798-9000
Taipei/ 886-2-2692-2000

FAX **Changhua**/ 886-4-798-9900
Taipei/ 886-2-2692-4000

DEALER

Please consult your dealer or G&G for overhaul maintenance and technical guidance.

▶ You may purchase all of the groups' parts from G&G support Dep.

▶ E-Mail: support@guay2.com

