

# G&G 16 series instruction manual



G&G ARMAMENT  
AIRSOFT GUNS & ACCESSORIES

## WARNING !!

- This product is suggested for users 18 years or older.
- Wear goggles while shooting.
- Incorrect use may cause injury or death.
- Never point at humans and animals with the airsoft guns.
- Read the whole manual before using.
- Buyers and users should obey the laws and rules of the local authority.

## CAUTION

1. Please select quality battery with the CE approval, to avoid any unnecessary damage on the product.
2. Please use either 8.4V or 9.6V battery, if different voltage used, it might damage the product.
3. Remove the battery from the product when it is not in use.
4. Do not wet nor incinerate the battery, nor to deform the terminal.

## FIRING MODE & SAFETY



Product appearance depends on actual goods



**SAFETY ON**  
The trigger cannot be pulled

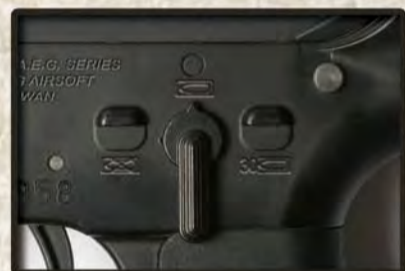

**SEMI AUTO**  
Single shot

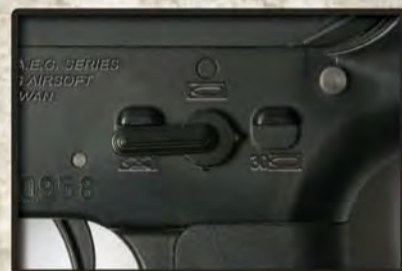

**FULL AUTO**  
Automatic firing



## BATTERY SETTING



1. Charge up the battery.  
2. Charging will be completed after 3 hours.



Pull out the butt plate from upper part.



Take out the battery stop.

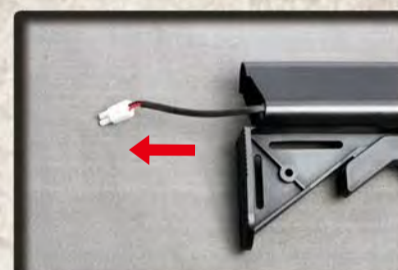

Pull out the wire connector.

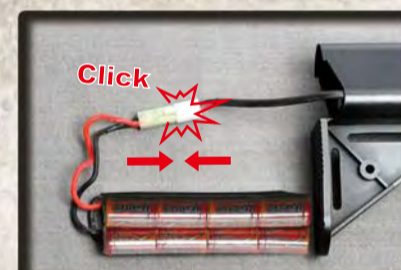

Click  
Connect battery plug with the connector until you heard a click sound.

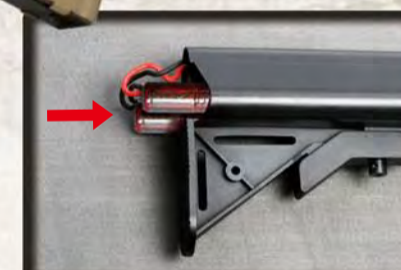

Insert the battery into stock.



Reinstall the battery cover and butt plate.

## SETTING MAGAZINE

### CAUTION

It is strongly recommended the use of G&G BB pellets only. Using low quality BB pellets will damage the product and void warranty.



Open the cover of magazine.



Load G&G 5.95mm BB pellets into the magazine.



Close the cover plate then turn the gear until the sound changes.



Click  
Insert the magazine until you heard a click sound.

## HOP-UP ADJUSTMENT

### CAUTION

Do not catch your fingers in the dummy bolt.  
Never hold the gun sideways as the BB pellets will curve right or left.



Turn to Normal Turn to Hop

Too much Hop-up.  
✗ ( Turn the adjust lever toward Normal )

Best Direction. ○

✗ Not enough Hop-up. ( Turn the adjust lever toward Hop )  
or Too much Hop-up. ( Turn the adjust lever toward Normal )

WWW.GUAY2.COM Printed in Taiwan  
Manufactured by G&G Armament





# GC16 series instruction manual

**WARNING !!**

- This product is suggested for users 18 years or older.
- Wear goggles while shooting.
- Incorrect use may cause injury or death.
- Never point at humans and animals with the airsoft guns.
- Read the whole manual before using.
- Buyers and users should obey the laws and rules of the local authority.

**CAUTION**

Keep the selector on Safe mode until you are actually ready to shoot.

Windage adjustment knob

Elevation adjustment knob

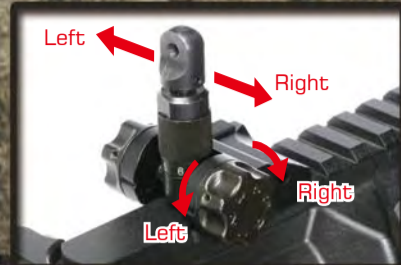

For rear sight left-right adjustment. Turning clockwise. Turning counter-clockwise more the pellet hitting to the right.

For rear sight up-down. Turning clockwise: Raise the pellet hitting point. Turning counter-clockwise: Lower the pellet hitting point.



SPECIAL SHOOTING

Used for precision firing.



COMMON SHOOTING

Used for full automatic firing.



WINDAGE KNOB (left / right adjustment)

ELEVATION KNOB (up / down adjustment)

## REAR SIGHT ADJUSTMENT

## RETRACTABLE STOCK

## MOVABLE PARTS

## MAINTENANCE

## RETRACTABLE STOCK

## MOVABLE PARTS

## TROUBLE SHOOTING



Press the stock release lever to unlock.



Adjust the position ( 6 position ).

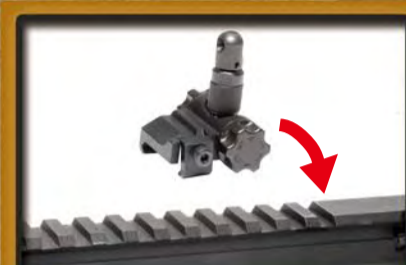

Detachable rear sight.



Unscrew the screw to disassemble the rear sight.

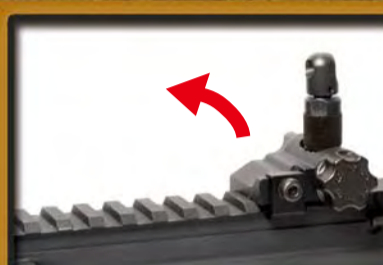

Take off the rear sight to install other accessories.

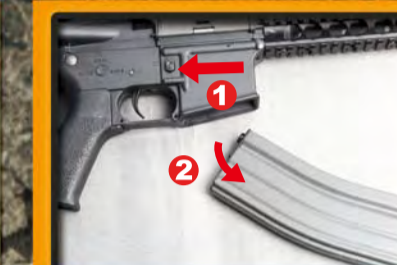

Remove the magazine.

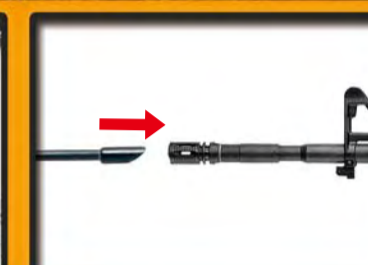

Return the hop up dial to normal position and insert the cleaning rod from the lead edge of the inner barrel.

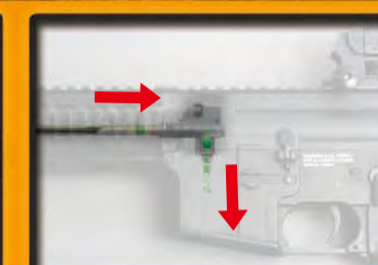

Be aware to have the rod facing down and reaching to the end, and remove clogged pellets.



Press the stock release lever to unlock.



Adjust the position ( 6 position ).



Detachable the carrying handle

Turn the knobs counterclockwise.



Take off carrying handle.



Dot sight (Optional)

You can buy other accessories to install on the rail system.



Adjust screw when the gear noise becomes shrilly.

The screw at bottom of the grip. Please use the screwdriver to adjust.



No operation

Check the wire set contact with motor.



No operation

Check the battery and connector.

## PARTS LIST

- GC16-01 Flash suppressor set
- GC16-02 Rail system set
- GC16-03 Rear sight base set
- GC16-04 Rear sight set
- GC16-05 Front barrel / Front sight set
- GC16-07 Barrel base set
- GC16-08 Piston rod
- GC16-09 Assist knob set
- GC16-10 Inner barrel
- GC16-11 Upper receiver set
- GC16-12 Charging handle set
- GC16-13 Hop-up set
- GC16-14 Port cover set
- GC16-15 Front frame lock pin set
- GC16-16 Bolt catch set

- GC16-17 Magazine catch set
- GC16-18 Selector lever set
- GC16-19 Stock washer
- GC16-20 Enhanced rod set
- GC16-21 Hi-cap 450R magazine
- GC16-22 Lower receiver set
- GC16-23 Trigger guard set
- GC16-24 Selector plate
- GC16-25 Rear frame lock pin set
- GC16-26 Grip
- GC16-27 Motor set
- GC16-28 Motor cap
- GC16-29 Extended stock set
- GC16-30 Rear wire set
- GC16-31 Gear box set

- GC16-06 Delta ring set
- GC16-32 Carrying handle set
- GC16-33 Rear outer barrel set
- GC16-34 Front outer barrel set

- GC16-35 Handguard set
- GC16-36 Retractable stock set
- GC16-37 Reinforced Grip for T4-18

## G&G ARMAMENT

ADDRESS **Changhua** / No. 999, Zhonghua Rd., Shengang Township, Changhua County 50952, Taiwan  
**(Head Quarter)**  
**Taipei** / 11F-3, NO.27, Lane 169, Kangning St, Shijr City, Taipei County 22180, TAIWAN

E-Mail **Sales Department** / sales@guay2.com  
b2b@guay2.com

**Technology support Department** / support@guay2.com

WEBSITE [www.GUAY2.com](http://www.GUAY2.com)

TEL **Changhua** / 886-4-798-9000  
**Taipei** / 886-2-2692-2000

FAX **Changhua** / 886-4-798-9900  
**Taipei** / 886-2-2692-4000

DEALER

Please consult your dealer or G&G for overhaul maintenance and technical guidance.

You may purchase all of the groups' parts from G&G support Dep.

E-Mail: support@guay2.com

