



# INSTRUCTION MANUAL

## GC4 G26 A1 BLK/DST



All G&G products are complied with CE and RoHS 2.0.  
 G&G Armament is also a certified manufacturer of ISO 9001.

### ⚠ WARNING !!

- Stop shooting when the battery power is low.
- Do not adjust the motor without authorization or by certified technician.
- Adult supervision required.
- Always wear eye protection when using this product.
- Misuse or careless handling of this product may cause injury.
- May be hazardous up to 50 meters.
- This product is intended for users 18 years or older.
- Read all instructions before using this product.
- The buyer and the user of this product shall adhere to all local laws regulating the usage and the ownership of airsoft guns.

### ⚠ CAUTION

Do not remove upper hand guard before gas tube knob is pulled to the end to avoid damage on the knob.



### RECOMMENDED BATTERY TYPE

**G-11-088**  
 Ni-MH 9.6V 1600mAh (Two-Piece)



### COMPONENTS

### ⚠ CAUTION

1. Please utilize a quality battery with CE approval to avoid any unnecessary damage on the product.
2. Please use either 8.4V or 9.6V battery, if different voltage used, it might damage the product.
3. Remove the battery from the product when it is not in use. Do not wet nor incinerate the battery, nor to deform the terminal.

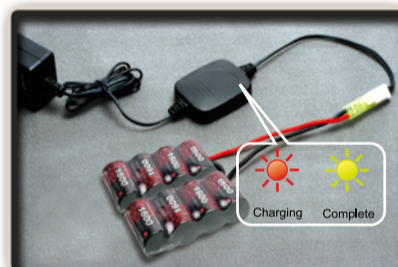

1. Charge up the battery.
2. Charging should be completed within 3 hours.

### CHARGING & INSTALLING BATTERIES

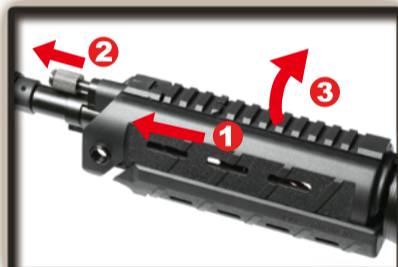

1. Push the upper handguard forward and pull the gas tube knob to the end, then remove upper hand guard.

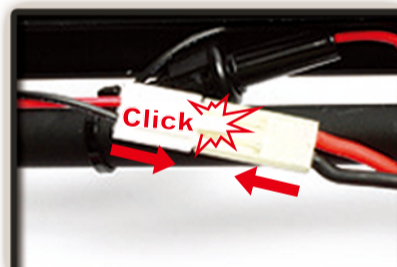

1. Connect battery plug with connector till clicks.

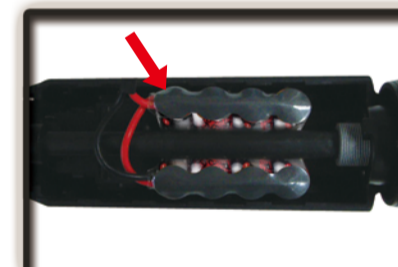

1. Insert the battery into lower handguard then reinstall upper handguard.



- SAFETY ON**  
 Will not fire



- SEMI AUTO**  
 Single shot



- FULL AUTO**  
 Automatic firing

### FIRING MODE & SAFETY

### ⚠ CAUTION

It is strongly recommended to use G&G BB pellets only. Using low quality BB pellets will shorten product life and void product warranty.



1. Open the top plate of magazine.



1. Load G&G 5.95mm BBs into the chamber and close the plate when the chamber is full.



1. Turn the winding wheel on the bottom of the magazine to tighten the spring. This will allow BBs to feed through the top of the magazine.



1. Insert the magazine into the Airsoft gun until it clicks into place.

### SETTING MAGAZINE

### ⚠ CAUTION

Keep the selector on Safe mode until you are ready to shoot.



1. Press the stock release lever to unlock.



1. Adjust the position ( 6 position ).



1. Press the lever to lock the stock position.



1. Extra Storage Space - Press the button then pull down.

### RETRACTABLE STOCK (GOS-V1)

### HOP-UP ADJUSTMENT

#### ⚠ CAUTION

Do not catch your fingers in the dummy bolt. Never hold the gun sideways as the BB pellets will curve right or left.



- ⊗ Too much Hop-up. ( Turn the adjust lever toward Normal )

Best Position. ○

- ⊗ Not enough Hop-up. ( Turn the adjust lever toward Hop ) or Too much Hop-up. ( Turn the adjust lever toward Normal )



# INSTRUCTION MANUAL

# GC4 G26 A1 BLK/DST



WWW.GUAY2.COM  
**G&G ARMAMENT**  
 AIRSOFT GUNS & ACCESSORIES

## TAIWAN

Sales Dept. | sales@guay2.com , b2b@guay2.com  
 Technology Support Dept. | support@guay2.com  
 PR Dept. | pr@guay2.com

Chang Hua | Tel : +886-4-798-9000 Fax : +886-4-798-9900  
 Headquarter | No.999, Zhonghua Rd. Shengang Township,  
 Changhua County 50955, Taiwan (R.O.C.)

Dealer

G2-201503-02-英

## SIGHT ADJUSTMENT

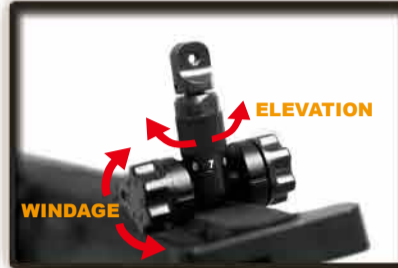

WINDAGE KNOB (left / right adjustment)  
 ELEVATION KNOB (up / down adjustment)



Rear Sight - Flip down or up



Front Sight - Flip down or up

## WHEN BB PELLETS ARE CLOGGED

1. Before you clean the inner barrel, make sure the hop up is turn to normal position.
2. Take a piece of cotton cloth about 1 inch by 0.5 inch and insert one end of the cloth into the hole of the tip of the cleaning rod and wrap it around the tip.

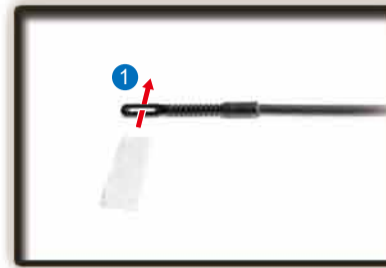

3. Apply a drop of silicone oil or Teflon oil on the cloth and insert the cleaning rod into the inner barrel.

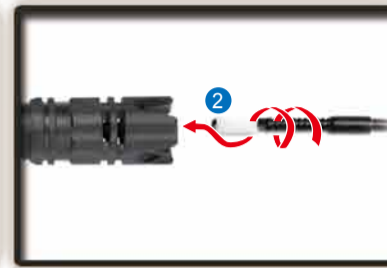

4. Check the cloth and repeat above steps until the cloth can't get any more dirt.

## TROUBLE SHOOTING



Adjust screw when the gear noise becomes shrilly.  
 The screw at bottom of the grip. Please use the screwdriver to adjust.



No operation  
 Check the wire set contact on the motor.

## MAINTENANCE

### CAUTION

Do not use CRC-556, WD40 or other corrosive lubricant.

For maintenance, use the silicon oil on the air nozzle, do not use other types of corrosive oil.



To avoid clogging of pellets, make sure that no dirt gets into the chamber. The hop up may take 200 to 300 rounds to remove the excessive silicone oil, this is the normal operation for the gun.



Remove the magazine.

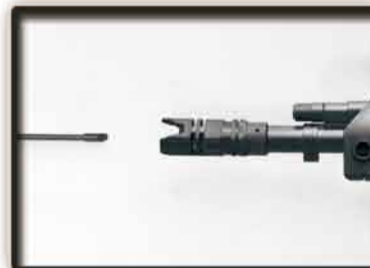

Return the hop up dial to normal position and insert the cleaning rod from the lead edge of the inner barrel.

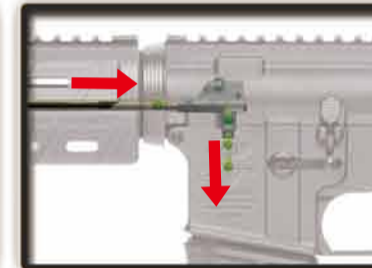

Be aware to have the rod facing down and reaching to the end, and remove clogged pellets.

### Disclaimer

- Adult supervision required for users who are under 18 years of age.
- The purchaser and user should conform to all laws governing the ownership of airsoft guns.
- All products in this manual are imitation firearms and are not intended nor represented to be comparable in design, appearance, or function to any actual firearm offered by other manufacturers.
- Accessories pictured are not always included with product.
- Product names are trademarks of G&G, which has no affiliation to, and is not associated, or sponsored by any manufacturer of actual or imitation firearms.
- Products may vary from those pictured.

## PARTS LIST

- |   |  |   |
|---|--|---|
| <b>GC4 G26 - 01</b> Flash Suppressor    | <b>GC4 G26 - 11</b> Front Frame Lock Pin Set | <b>GC4 G26 - 21</b> Rear Frame Lock Pin Set |
| <b>GC4 G26 - 02</b> Front Barrel Set    | <b>GC4 G26 - 12</b> Bolt Catch Set           | <b>GC4 G26 - 22</b> Grip Set                |
| <b>GC4 G26 - 03</b> Lower Handguard Set | <b>GC4 G26 - 13</b> Selector Lever Set       | <b>GC4 G26 - 23</b> Motor                   |
| <b>GC4 G26 - 04</b> Upper Handguard Set | <b>GC4 G26 - 14</b> Magazine Catch Set       | <b>GC4 G26 - 24</b> Grip Bottom Set         |
| <b>GC4 G26 - 05</b> Hop-up Set          | <b>GC4 G26 - 15</b> Stock Washer             | <b>GC4 G26 - 25</b> Gos-v1 Stock Set        |
| <b>GC4 G26 - 06</b> Slip Ring           | <b>GC4 G26 - 16</b> Enhanced Rod Set         | <b>GC4 G26 - 26</b> Gear Box Set            |
| <b>GC4 G26 - 07</b> Inner Barrel        | <b>GC4 G26 - 17</b> Gmag-v1 Magazine         | <b>GC4 G26 - 27</b> Barrel Base Set         |
| <b>GC4 G26 - 08</b> Upper Receiver Set  | <b>GC4 G26 - 18</b> Lower Receiver Set       | <b>GC4 G26 - 28</b> Selector Plate          |
| <b>GC4 G26 - 09</b> Charging Handle Set | <b>GC4 G26 - 19</b> Trigger Guard Set        | <b>GC4 G26 - 29</b> Rear Sight              |
| <b>GC4 G26 - 10</b> Port Cover Set      | <b>GC4 G26 - 20</b> Selector Plate           | <b>GC4 G26 - 30</b> Front Wire              |

## TROUBLE SHOOTING

SYMPTOM	POTENTIAL	CORRECTIVE
No operation at all	Selector lever is set to safety.	Set the selector lever to Semi.
	Battery is not charged.	Charge the battery.
	Battery connector is disconnected.	Attach the connector.
	Battery connectors (+ and -) are reversed.	Connect the connector correctly(check the fuse)
Although motor is revolving, no pellet can be fired	Motor life expired (50,000 to 60,000 rounds) or poor electrical connection.	Replace the dead motor (can be purchased from local dealer or directly G&G). Check and repair the contacts.
	Pellets are clogged inside the magazine.	Insert the charging rod into the magazine and move up and down a few times to remove clogged pellets.
Shooting distance becomes shorter	Pellets are clogged in the chamber.	Remove clogged pellets by using the cleaning rod.
	Faulty gear.	Prurchase the replacement gear from your dealer or G&G and repair.
	Damaged or worn chamber set.	Mount the replacement parts(Purchasing from your dealer or G&G).
Too loud operating noise	Damaged or worn piston set (O-ring,piston spring).	Use the cleaning rod and clean the inner barrel.
	Something is jammed in the inner barrel.	Use the genuine G&G Pellets.
	Faulty BB pellets (too small or heavy).	Drops few drops of silicone oil from upper the chamber.
	Shrotage of silicone oil.	
Pellets being fallen out from barrel end	Gear problem caused by too many blank firing.	
	Worn or damaged gear.	Consult your dealer or G&G for overhaul maintenance, part replacement (gear,etc.) or repair.
If gun gets wet	Gear problem caused by too many blank firing.	
	Damaged or worn chamber set.	
	No hop setting.	Turn the hop adjustment lever toward Hop.
	Faulty BB Pellets (too small or heavy).	Use the G&G Pellets.
		Stop operation immediately, disconnect the battery, wipe off water from inside the main body and the battery. After completely dry, carry out trial firing. If the unit is not operational, please contact your local dealer for repair.

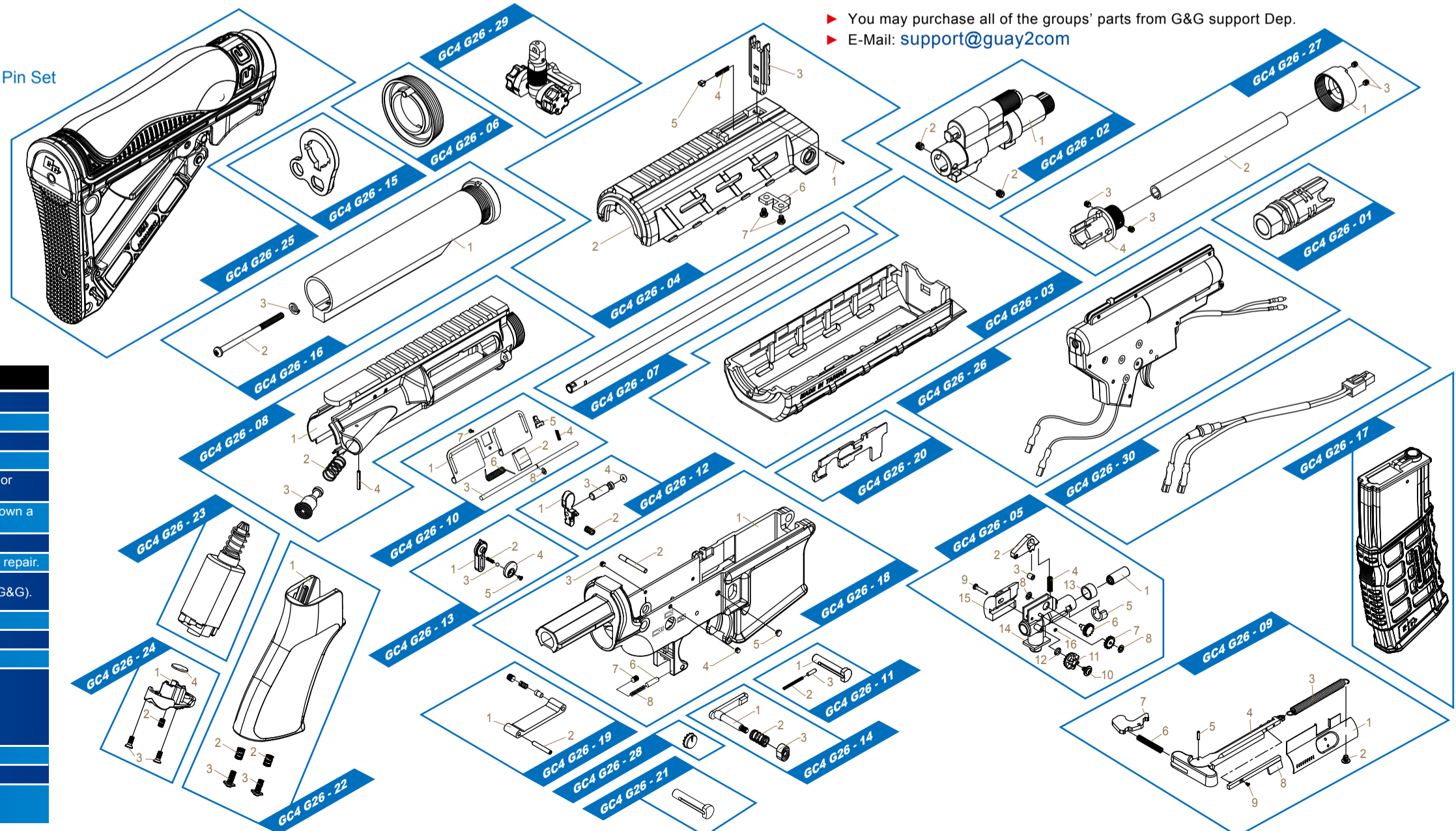

▶ You may purchase all of the groups' parts from G&G support Dep.  
 ▶ E-Mail: support@guay2.com