

# INSTRUCTION MANUAL

# GR4 100Y

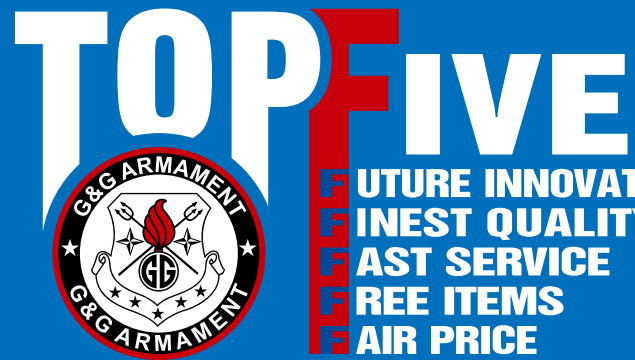

**TOP FIVE**  
 FUTURE INNOVATION  
 BEST QUALITY  
 FAST SERVICE  
 FREE ITEMS  
 AIR PRICE



**SPECIAL SHOOTING**  
 Used for precision firing.



**COMMON SHOOTING**  
 Used for full automatic firing.



**WINDAGE KNOB** (left / right adjustment)  
**ELEVATION KNOB** (up / down adjustment)

## REAR SIGHT ADJUSTMENT

**CAUTION**  
 Keep the selector on Safe mode until you are actually ready to shoot.

## RETRACTABLE STOCK

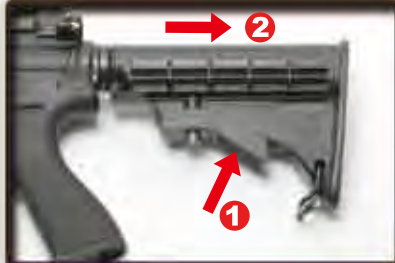

Press the stock release lever to unlock.



Adjust the position ( 6 position ).

## WINDAGE ADJUSTMENT KNOB



Detachable rear sight.



Turn the knobs counterclockwise to disassemble the rear sight.



Take off the rear sight to install other accessories.

## MAINTENANCE



Remove the magazine.

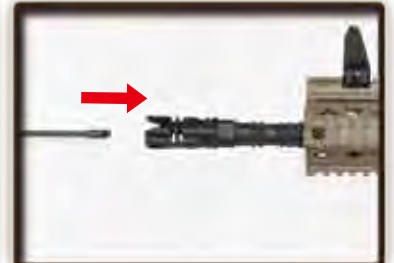

Return the hop up dial to normal position and insert the cleaning rod from the lead edge of the inner barrel.

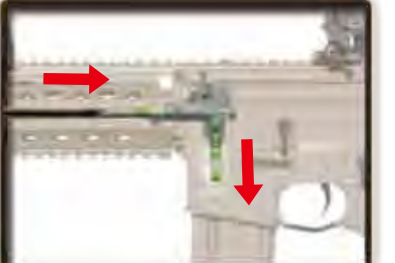

Be aware to have the rod facing down and reaching to the end, and remove clogged pellets.

## OPTIONAL PARTS



**G-12-006**  
 CD13-TRT30GD Red-Dot Scope



**G-03-105**  
 SCAR BIPOD GRIP

## FOLDING THE STOCK

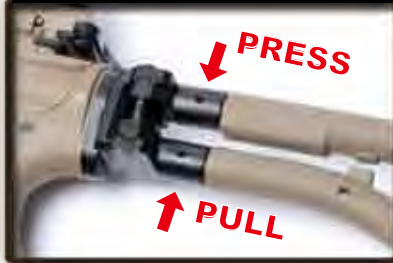

Press and Pull the stock to unlock.



Folding the stock.



Turn the folding stock to be locked.

## TROUBLE SHOOTING



Adjust screw when the gear noise becomes shrilly.

The screw at bottom of the grip. Please use the screwdriver to adjust.



No operation

Check the wire set contact with motor.



No operation

Check the battery and connector.

## PARTS LIST

- |                     |                          |                     |                            |
|---------------------|--------------------------|---------------------|----------------------------|
| <b>GR4 100Y- 01</b> | Flash suppressor set     | <b>GR4 100Y- 18</b> | Lower receiver set         |
| <b>GR4 100Y- 02</b> | Rail system set          | <b>GR4 100Y- 19</b> | Trigger guard set          |
| <b>GR4 100Y- 03</b> | Rear sight base set      | <b>GR4 100Y- 20</b> | Selector plate             |
| <b>GR4 100Y- 04</b> | Rear sight set           | <b>GR4 100Y- 21</b> | Rear frame lock pin set    |
| <b>GR4 100Y- 05</b> | Hop-up set               | <b>GR4 100Y- 22</b> | Grip                       |
| <b>GR4 100Y- 06</b> | Upper receiver rail set  | <b>GR4 100Y- 23</b> | Motor set                  |
| <b>GR4 100Y- 07</b> | Inner barrel             | <b>GR4 100Y- 24</b> | Grip bottom set            |
| <b>GR4 100Y- 08</b> | Upper receiver set       | <b>GR4 100Y- 25</b> | Extended stock set         |
| <b>GR4 100Y- 09</b> | Charging handle set      | <b>GR4 100Y- 26</b> | Gear box set               |
| <b>GR4 100Y- 10</b> | Port cover set           | <b>GR4 100Y- 27</b> | Barrel base set            |
| <b>GR4 100Y- 11</b> | Front frame lock pin set | <b>GR4 100Y- 28</b> | Blow back pneumatic piston |
| <b>GR4 100Y- 12</b> | Bolt catch set           | <b>GR4 100Y- 29</b> | Charging plate             |
| <b>GR4 100Y- 13</b> | Selector lever set       | <b>GR4 100Y- 30</b> | Charging upper cover       |
| <b>GR4 100Y- 14</b> | Magazine catch set       | <b>GR4 100Y- 31</b> | Switch plate               |
| <b>GR4 100Y- 15</b> | Stock washer             | <b>GR4 100Y- 32</b> | Folding stock set          |
| <b>GR4 100Y- 16</b> | Enhanced rod set         | <b>GR4 100Y- 33</b> | Front sight set            |
| <b>GR4 100Y- 17</b> | Hi-cap 450R magazine     | <b>GR4 100Y- 34</b> | Folding stock base set     |

## MANUFACTURED BY G&G ARMAMENT

### TAIWAN

Sales Dept. | sales@guay2.com , b2b@guay2.com  
 Technology Support Dept. | support@guay2.com  
 PR Dept. | pr@guay2.com

**Chang Hua** Headquarter  
 Tel : +886-4-798-9000 Fax : +886-4-798-9900  
 No.999, Zhonghua Rd. Shengang Township,  
 Changhua County 50955, Taiwan (R.O.C.)

**Taipei**  
 Tel : +886-2-2692-2000 Fax : +886-2-2692-4000  
 11F-3., No.27, Lane 169, Kangning St. Shijr City,  
 Taipei County 22180, Taiwan (R.O.C.)

### U.S.A.

E-mail | sales101@guay2.com

**Los Angeles**  
 Tel : +1-626-581-0101  
 Fax : +1-626-581-1011  
 1122 Coiner Court,  
 City of Industry,  
 CA 91748 (U.S.A.)

Dealer

G2-201401-08-英

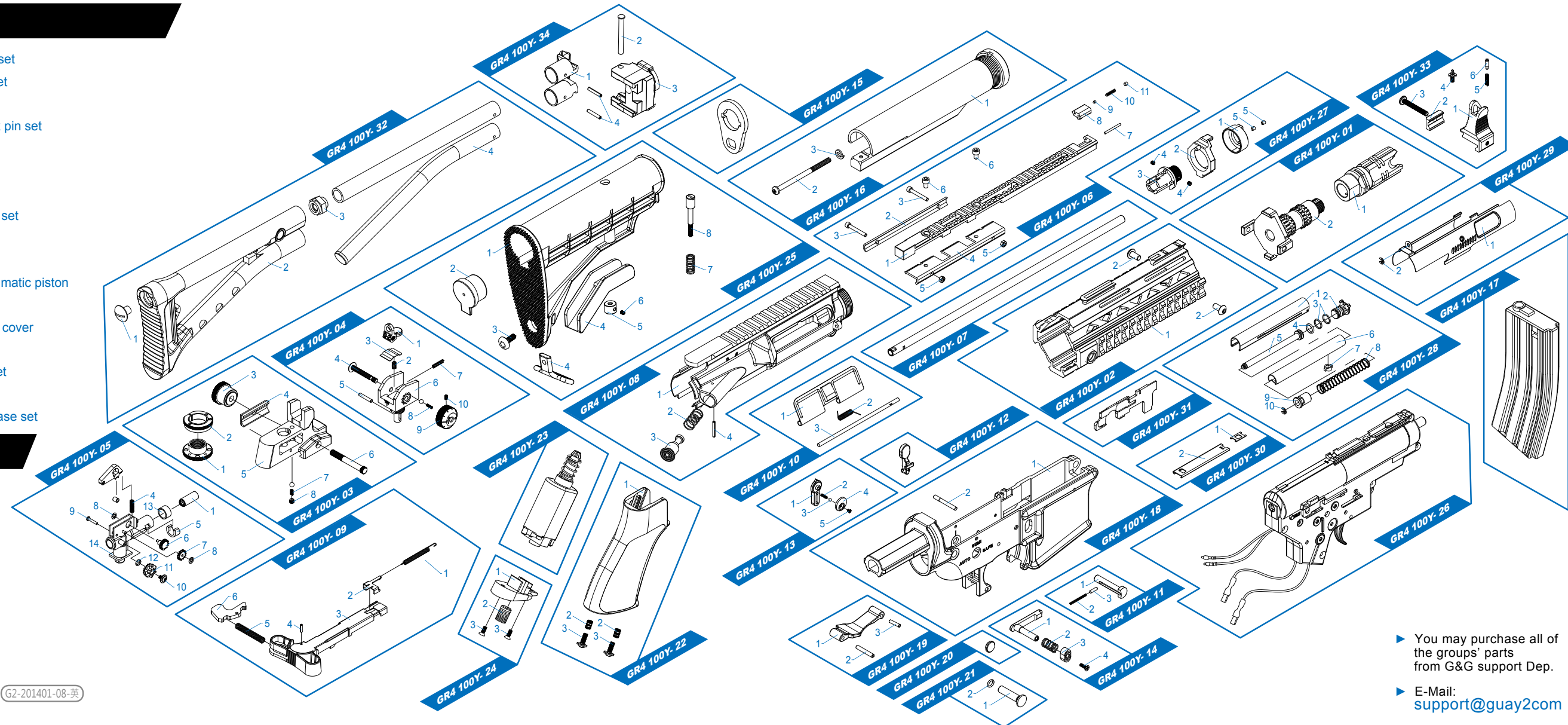

▶ You may purchase all of the groups' parts from G&G support Dep.  
 ▶ E-Mail: support@guay2com