

After take off parts, please follow the step to install G960.

# G960

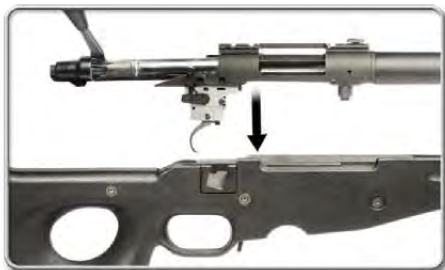

**G&G ARMAMENT**  
AIRSOFT GUNS & ACCESSORIES



Connect the upper part of bolt and barrel into the receiver.

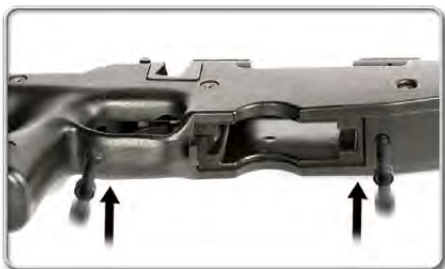

Lock the screws.



1. Press the magazine catch.  
2. Insert the magazine into receiver.



1. Push the bolt lever forward.  
2. Pull the bolt lever down.

This Product not including Scope, Bipod



**ASSEMBLY INSTRUCTION** MANUFACTURED BY G&G ARMAMENT [WWW.GUAY2.COM](http://WWW.GUAY2.COM)

# G960

MANUFACTURED BY G&G ARMAMENT [WWW.GUAY2.COM](http://WWW.GUAY2.COM)



**G&G ARMAMENT**  
AIRSOFT GUNS & ACCESSORIES



Adult supervision required.  
Always wear safety goggles when using this product.  
Misuse or careless handling of this product may cause injury.  
May be hazardous up to 50 meters.  
This product is intended for users 18 years or older.  
Read all instructions before using this product.  
The buyer and the user of this product shall adhere to all local laws regulating the usage and the ownership of airsoft guns.

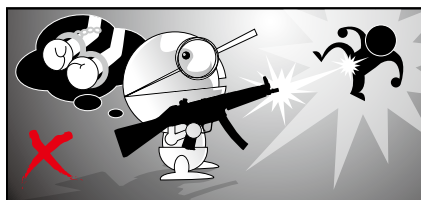

You may be liable for damaging public or personal property or for injuring a person or an animal even if you only meant to shoot as a "practical joke." Always observe good manners and enjoy fun sport shooting.

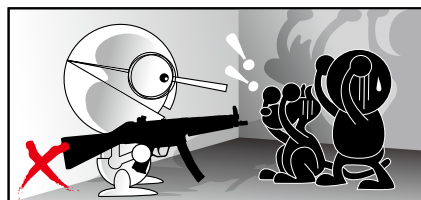

Never direct the muzzle towards a person, animal or in any direction. That may cause harm or damage to the third party.

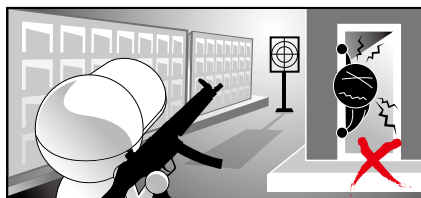

Select a safe place for operating the air gun, avoid places where people and cars are around.



Make sure to put the barrel and safety cap on the muzzle, except when you are shooting. Do this to prevent accident, discharge of BB's and also for dust protection purpose. Never pull the trigger while the barrel and the safety cap is attached.

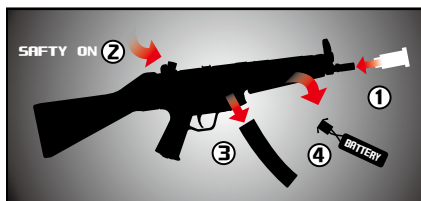

Safety procedures:  
1. Attach the safety cap to the muzzle.  
2. Set the selector lever to the safety position.  
3. Remove the magazine.  
4. Remove the battery.



Looking into the muzzle is extremely dangerous regardless of BB's having been loaded or not. If you get hit in the eye by a BB pellet, you may in worst case, lose your eye sight.



When you carry the air gun, attach the safety cap, set the selector lever to the safety position and always put the air gun in a case or bag.



Activating the trigger carelessly is extremely dangerous. Never put your finger on the trigger unless the safety cap is removed and you are ready to shoot a target.



When shooting the air guns for target practice or in a game situation, you and all participants must wear safety goggles or other eye protective gear. Also, pay attention to ricochets. It is very important to pay attention to third parties other than the participants.

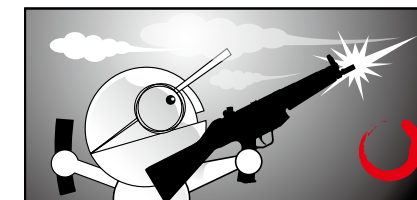

There may be cases where some BB's remain in the gun after the magazine has been removed. After removal of the magazine, direct the muzzle towards a safe direction and pull the trigger to confirm that there are no BB's remain in the gun, then attach the safety cap.



Always attach the safety cap to the muzzle, remove the battery and store the air gun in a case or bag and at a place that is out of reach by children.

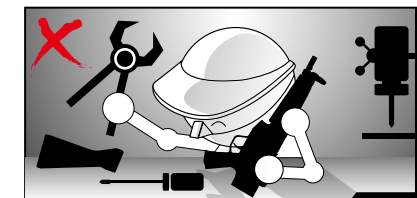

Disassembling or modifying the gun may adversely affect the performance and make it dangerous. "It may be against the Law."



Never put the gun and gas at a place that is exposed to temperatures over 40°C (140°F).



It is prohibited to use the gas with pressure over 12 kg, it will damage the product and is dangerous.

## Installation



STEP 1

1. lift the bolt lever.
2. Pull the bolt lever backward.



STEP 2

1. Press magazine catch button.
2. Remove the magazine.



STEP 3

Filling gas into the magazine.



STEP 4

Load G&G 5.95 mm BB pellets into the magazine.



STEP 5

Insert the magazine into receiver.



STEP 6

1. Push the bolt lever forward.
2. Pull the bolt lever down.

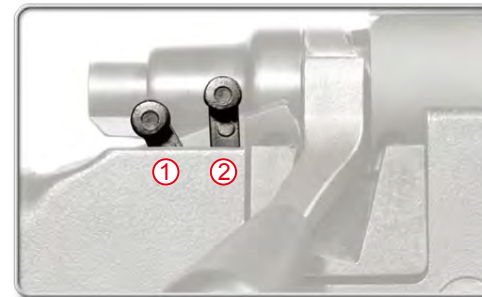

STEP 7

1. When you are not firing the gun, set the selector to the safe position(1).
2. Setting the selector to the position(2), the gun will fire one shot each time as pull the trigger

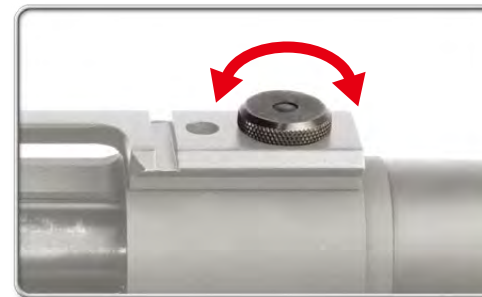

STEP 8

1. Turning counterclockwise:Raises the pellet hitting point.
2. Turning clockwise:Lower the pellet hitting point.



## Trigger Adjustment

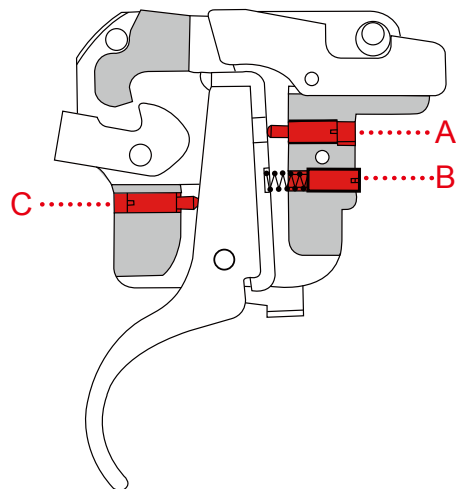

### A. Trigger moving range (screw adjustment)

Turning clockwise: Decrease trigger moving range.  
Turning counterclockwise: Increase trigger moving range.

### B. Activating the trigger bearing (screw adjustment)

Turning clockwise: Increase the trigger activating bearing.  
Turning counterclockwise: Decrease the trigger activating bearing.

### C. Firing control metal (screw adjustment)

Turning clockwise: Decrease the trigger activating time.  
Turning counterclockwise: Increase the trigger activating time.



STEP 1

Make sure no BB pellets get into the bolt.



STEP 2

Press the bolt release button.



STEP 3

Take off the bolt lever.



STEP 4

Take off the magazine.

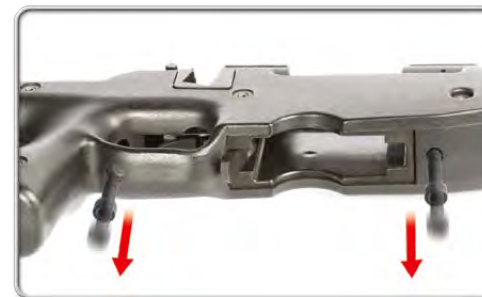

STEP 5

Remove the two screws.



STEP 6

Take off the upper receiver.  
Disassembly completed.

▶ You may buy all of the groups' parts from G&G ARMAMENT support Dep.  
▶ E-mail : support@guay2.com

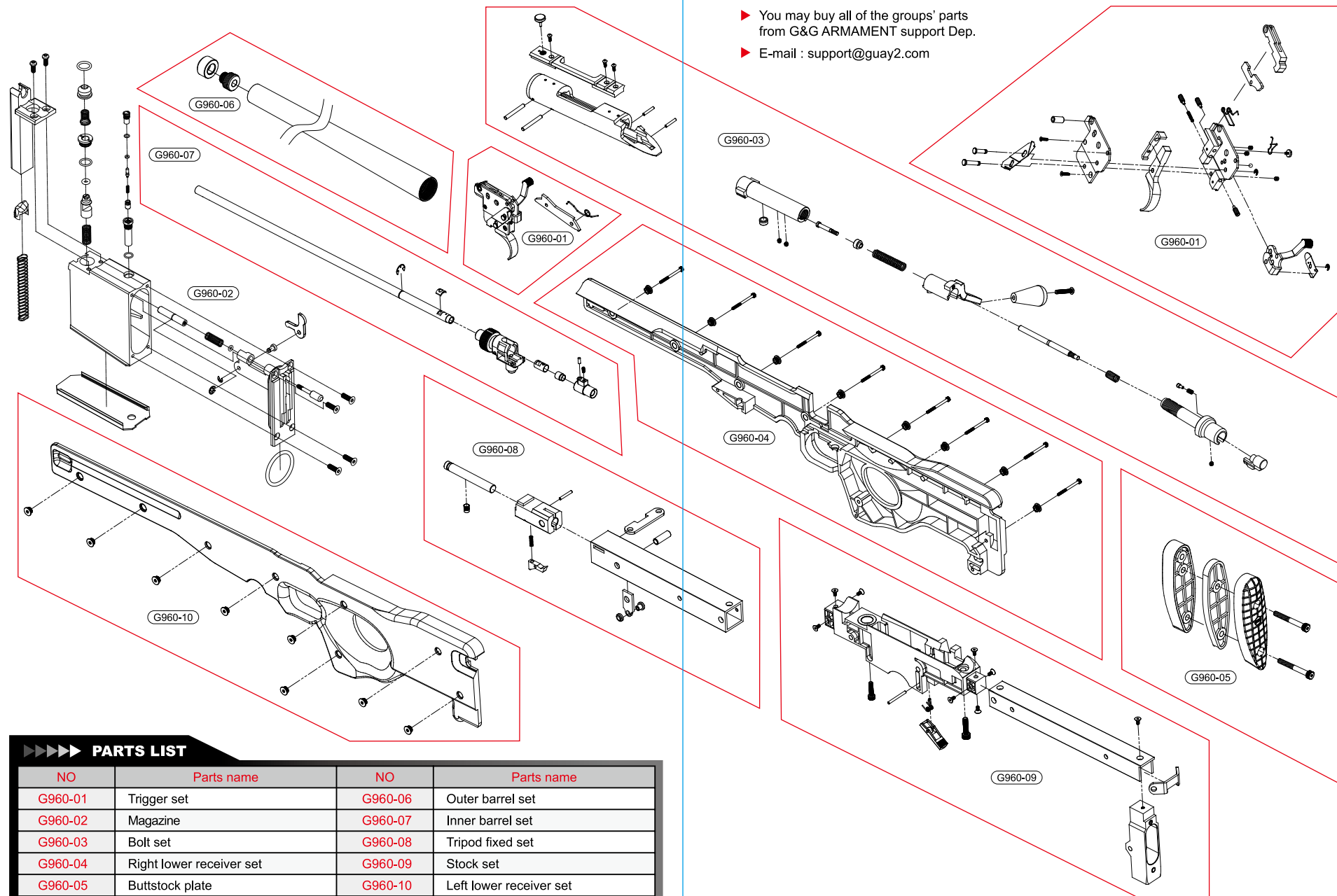

▶▶▶▶ PARTS LIST			
NO	Parts name	NO	Parts name
G960-01	Trigger set	G960-06	Outer barrel set
G960-02	Magazine	G960-07	Inner barrel set
G960-03	Bolt set	G960-08	Tripod fixed set
G960-04	Right lower receiver set	G960-09	Stock set
G960-05	Buttstock plate	G960-10	Left lower receiver set

**TROUBLE CLINIC**

SYMPTOM	CAUSE	ACTION
No operation at all	Selector lever is set to safety.	Set the selector lever to Semi or Full Auto.
	Battery is not charged.	Change the battery.
	Battery connector is disconnected.	Connect the connector.
	The ⊕ and ⊖ of battery connector is reversed.	Connect the connector correctly(check the fuse).
Although motor is revolving, no pellet can be fired	Expired motor life(50,000 to 60,000 rounds) or poor electrical connection.	Replace the motor(purchasing from your dealer or us) or check and repair the contacts.
	Pellets are clogged inside the magazine.	Insert the cleaning rod into the magazine and move up and down a few times to remove clogged pellets.
Full-auto operation not functional (automatic firing)	Pellets are clogged in the chamber.	Remove clogged pellets using the cleaning rod.
	Faulty gear.	Purchase the replacement gear from your dealer or G&G and repair.
	Insufficient battery power.	Charge the battery.
Shooting distance becomes shorter	Magazine feed with faulty pellet.	Repair clogging of the magazine.
	Poor electrical connection.	Consult your dealer or us for overhaul maintenance or repair.
	Damaged or worn chamber set.	Replace the replacement parts.(Purchasing from your dealer or G&G)
	Damaged or worn piston set (O-ring, piston spring).	
	Something is jammed in the inner barrel.	Use the cleaning rod and clean the inner barrel.
	Faulty BB pellets (too small or heavy).	Use the genuine G&G Pellets.
Shortage of silicone oil.	Drop a few drops of silicone oil from the chamber upper.	
Too loud operating noise	Gear problem caused by too many blank firing.	Consult your dealer or G&G for overhaul maintenance,part replacement (gear,etc.) or repair.
	Worn or damaged gear.	
Pellets being fallen out from barrel end	Damaged or worn chamber set.	Turn the hop adjustment lever toward Hop.
	No hop setting.	
	Faulty BB pellets (too small ).	
If gun gets wet	<b>Stop operation immediately,disconnect the battery,wipe off water from inside the main body and the battery. After completely dried, carry out trial firing. If the unit is not operational, please contact your local dealer for repair.</b>	

**When Hopping Up is improper**

SYMPTOM	POTENTIAL	CORRECTIVE
Pellets flying upwards	Too much hop setting.	Gradually return adjustment lever towards Normal.
	Too much hop setting	Gradually return adjustment lever towards Normal.
Short flying distance of pellets(less hopping up effect)	Hop packing contaminated by oil or dirt	Fire pellets equivalent to 4 to 5 magazine or clean the chamber using cleaning rod.
	Dirt inside a barrel	
	Worn or damaged hop packing.	Purchase the replacement part at your dealer or from G&G and replace it.
Cannot adjust	Damaged adjustment lever or other parts	Purchase the replacement part at your dealer or from G&G and replace it.
Frequent pellet clogging	Too much hop setting	Gradually return adjustment lever towards Normal.
	Improper or too large sized BB pellets.	Use the BB pellet supplied by G&G ARMAMENT.
	Dirty hop packing	Clean using the cleaning rod or consult your dealer or G&G for repair.



**G&G ARMAMENT**  
AIRSOFT GUNS & ACCESSORIES

**MANUFACTURED BY G&G ARMAMENT**

**Address:**

No.999, Zhonghua Rd. Shengang Township, Changhua County 50952, Taiwan (R.O.C.)

**TEL:**

+886-4-798-9000

**FAX:**

+886-4-798-9900

**Website:**

<http://www.guay2.com>

**E-Mail:**

Sales Department : [sales@guay2.com](mailto:sales@guay2.com) , [b2b@guay2.com](mailto:b2b@guay2.com)

Customer Support Department : [support@guay2.com](mailto:support@guay2.com)

**DISCLAIMER**

- \* Accessories pictured are not always included with product.
- \* Adult supervision is required for users under 18 years of age.
- \* The purchaser and user should conform to all laws governing and ownership of airsoft guns.
- \* All products in this catalog are imitation firearms and are not intended nor represented to be comparable in design,appearance,or function to any actual firearm offered by other manufacturers.
- \* Product names are trademarks of G&G, which has no affiliation to, and is not associated,or sponsored by any manufacturer of actual or imitation firearms. Products may vary form those pictured.



Please consult your dealer or G&G for overhaul maintenance and technical guidance.