



# INSTRUCTION MANUAL

## CM16 Carbine BLK/DST CM16 Raider BLK/DST

### ⚠ WARNING !!

- Adult supervision required.
- Always wear eye protection when using this product.
- Misuse or careless handling of this product may cause injury.
- May be hazardous up to 50 meters.
- This product is intended for users 18 years or older.
- Read all instructions before using this product.
- The buyer and the user of this product shall adhere to all local laws regulating the usage and the ownership of airsoft guns.



### FIRING MODE & SAFETY

#### ⚠ CAUTION

1. Please select quality battery with the CE approval, to avoid any unnecessary damage on the product.
2. Please use either 8.4V or 9.6V battery, if different voltage used, it might damage the product.
3. Remove the battery from the product when it is not in use.
4. Do not wet nor incinerate the battery, nor to deform the terminal.



**SAFETY ON**  
The trigger cannot be pulled



**SEMI AUTO**  
Single shot



**FULL AUTO**  
Automatic firing

### COMPONENTS

### BATTERY SETTING

#### CM16 RAIDER BATTERY SETTING



1. Charge up the battery.
2. Charging will be completed after 3 hours.

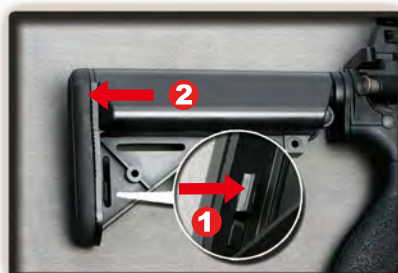

1. Push the butt plate lock ( both sides )
2. Pull out the butt plate.



Take off the cover.

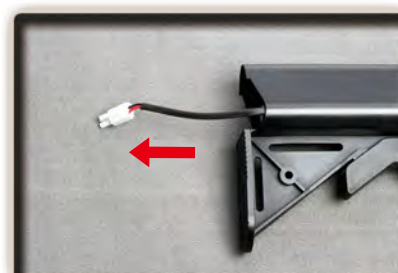

Pull out the wire connector.



Connect battery plug with the connector until you heard a click sound.



Insert the battery into stock.



Reinstall the battery cover and butt plate.

#### CM16 CARBINE BATTERY SETTING



1. Pull the slip ring and hold.
2. Disassemble the lower handguard.



Connect battery plug with the connector.



1. Pull the slip ring and hold.
2. Reinstall the lower handguard.



Finish.

### SETTING MAGAZINE

#### ⚠ CAUTION

It is strongly recommended the use of G&G BB pellets only. Using low quality BB pellets will shorten product life span and void product warranty.



Open the cover of magazine.



Load G&G 5.95mm BB pellets into the magazine.



Close the cover plate then turn the gear until the sound changes.



Insert the magazine until you heard a click sound.

### HOP-UP ADJUSTMENT

#### ⚠ CAUTION

Do not catch your fingers in the dummy bolt. Never hold the gun sideways as the BB pellets will curve right or left.



Turn to Normal Turn to Hop

- Too much Hop-up. ☒ ( Turn the adjust lever toward Normal )
- Best Position. ☐
- Not enough Hop-up. ( Turn the adjust lever toward Hop ) or Too much Hop-up. ( Turn the adjust lever toward Normal )





# INSTRUCTION MANUAL

## CM16 Carbine BLK/DST

## CM16 Raider BLK/DST



### WARNING !!

- Adult supervision required.
- Always wear eye protection when using this product.
- Misuse or careless handling of this product may cause injury.
- May be hazardous up to 50 meters.

- This product is intended for users 18 years or older.
- Read all instructions before using this product.
- The buyer and the user of this product shall adhere to all local laws regulating the usage and the ownership of airsoft guns.

**CAUTION**  
Keep the selector on Safe mode until you are actually ready to shoot.



### REAR SIGHT ADJUSTMENT



**SPECIAL SHOOTING**  
Used for precision firing.



**COMMON SHOOTING**  
Used for full automatic firing.

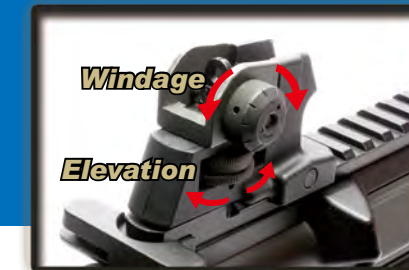

**WINDAGE KNOB** (left / right adjustment)  
**ELEVATION KNOB** (up / down adjustment)

### MAINTENANCE

### RETRACTABLE STOCK MOVABLE PARTS

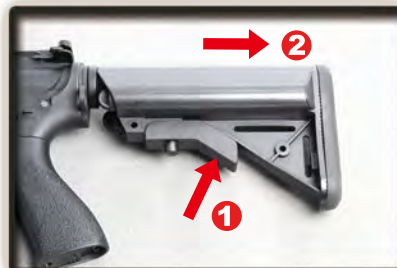

Press the stock release lever to unlock.



Adjust the position ( 6 position ).



Detachable rear sight.



Turn the knobs counterclockwise to disassemble the rear sight.



Take off the rear sight to install other accessories.



Remove the magazine.

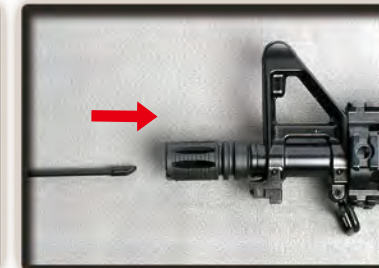

Return the hop up dial to normal position and insert the cleaning rod from the lead edge of the inner barrel.

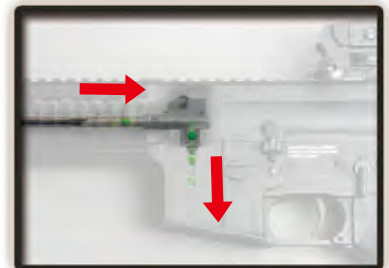

Be aware to have the rod facing down and reaching to the end, and remove clogged pellets.

### RETRACTABLE STOCK MOVABLE PARTS



Press the stock release lever to unlock.



Adjust the position ( 6 position ).



Detachable the carrying handle

Turn the knobs counterclockwise.



Take off carrying handle.

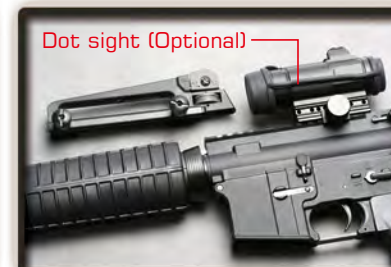

Dot sight (Optional)

You can buy other accessories to install on the rail system.



Adjust screw when the gear noise becomes shrilly.

The screw at bottom of the grip. Please use the screwdriver to adjust.



No operation

Check the wire set contact with motor.

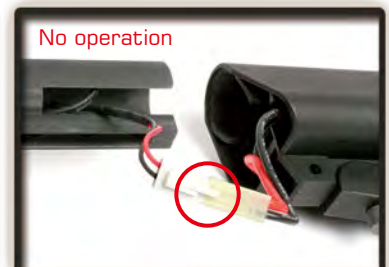

No operation

Check the battery and connector.

### PARTS LIST

#### For CM16 Raider / CM16 Carbine

- CM16 Raider- 01** Flash suppressor set  
**CM16 Raider- 02** Rail system set  
**CM16 Raider- 03** Rear sight base set  
**CM16 Raider- 04** Rear sight set  
**CM16 Raider- 05** Front barrel / Front sight set  
**CM16 Raider- 07** Barrel base set  
**CM16 Raider- 08** Piston rod  
**CM16 Raider- 09** Assist knob set  
**CM16 Raider- 10** Inner barrel  
**CM16 Raider- 11** Upper receiver set  
**CM16 Raider- 12** Charging handle set  
**CM16 Raider- 13** Hop-up set  
**CM16 Raider- 14** Port cover set  
**CM16 Raider- 15** Front frame lock pin set  
**CM16 Raider- 16** Bolt catch set

- CM16 Raider- 17** Magazine catch set  
**CM16 Raider- 18** Selector lever set  
**CM16 Raider- 19** Stock washer  
**CM16 Raider- 20** Enhanced rod set  
**CM16 Raider- 21** Hi-cap 450R magazine  
**CM16 Raider- 22** Lower receiver set  
**CM16 Raider- 23** Trigger guard set  
**CM16 Raider- 24** Selector plate  
**CM16 Raider- 25** Rear frame lock pin set  
**CM16 Raider- 26** Grip  
**CM16 Raider- 27** Motor set  
**CM16 Raider- 28** Grip bottom set  
**CM16 Raider- 29** Extended stock set  
**CM16 Raider- 30** Rear wire set  
**CM16 Raider- 31** Gear box set

#### For CM16 Carbine

- CM16 Carbine- 06** Slip ring set  
**CM16 Carbine- 32** Carrying handle set  
**CM16 Carbine- 33** Rear outer barrel set

- CM16 Carbine- 34** Front outer barrel set  
**CM16 Carbine- 35** Handguard set  
**CM16 Carbine- 36** Retractable stock set

**ADDRESS** **Changhua** / No. 999, Zhonghua Rd., Shengang Township, Changhua County 50952, Taiwan  
**(Head Quarter)**  
**Taipei** / 11F-3, NO.27, Lane 169, Kangning St, Shijr City, Taipei County 22180, TAIWAN

**E-Mail** **Sales Department** / sales@guay2.com  
b2b@guay2.com

**Technology support Department** / support@guay2.com

**WEBSITE** www.GUAY2.com

**TEL** **Changhua** / 886-4-798-9000  
**Taipei** / 886-2-2692-2000

**FAX** **Changhua** / 886-4-798-9900  
**Taipei** / 886-2-2692-4000

### DEALER

G2-201309-01-英

Please consult your dealer or G&G for overhaul maintenance and technical guidance.

▶ You may purchase all of the groups' parts from G&G support Dep.

▶ E-Mail: support@guay2.com

### TROUBLE SHOOTING

