



**WWW.GUAY2.COM**  
**G&G ARMAMENT**  
 AIRSOFT GUNS & ACCESSORIES

All G&G products are complied with CE and RoHS 2.0.  
 G&G Armament is also a certified manufacturer  
 of ISO 9001.

# INSTRUCTION MANUAL

## GC12 S.P.R.



### ⚠ WARNING !!

- Stop shooting when the battery power is low.
- Do not adjust the motor without authorization or by certified technician.
- This product is intended for users 18 years or older.
- Always wear eye protection when using this product.
- Misuse or careless handling of this product may cause injury.
- May be hazardous up to 50 meters.

- Adult supervision required.
- Read all instructions before using this product.
- The buyer and the user of this product shall adhere to all local laws regulating the usage and the ownership of airsoft guns.

### FIRING MODE & SAFETY

### CHARGING & INSTALLING BATTERIES

#### ⚠ CAUTION

1. Please use quality battery with the CE to avoid any unnecessary damage on the product.
2. Use recommended batteries only. Defected or low quality batteries might damage the product.
3. Remove the battery from the product when it is not in use.
4. Do not wet nor incinerate the battery, nor to deform the terminal.

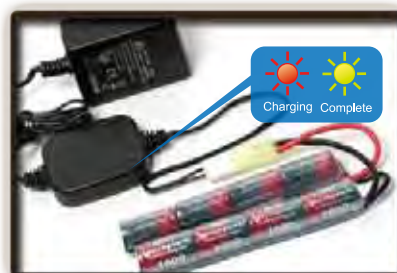

1. Charge up the battery.
2. Charging will be completed after 3 hours.

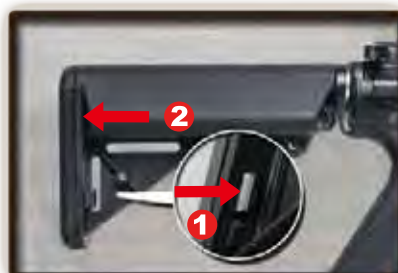

1. Push the butt plate lock ( both sides )
2. Pull out the butt plate.



Take off the cover.

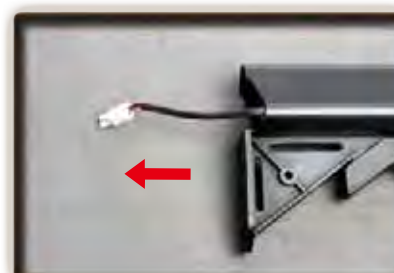

Pull out the wire connector.



Connect battery plug with the connector until click into place



Insert the battery into stock.



Reinstall the battery cover and butt plate.

### FRONT SIGHT ADJUSTMENT

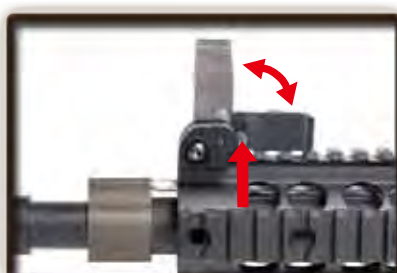

Press down the button to fold the front sight.



Turn the screw counterclockwise.

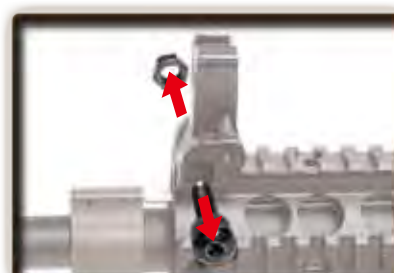

Remove the screw and screw nut.



Remove the front sight.

### LOADING MAGAZINE

#### ⚠ CAUTION

We strongly recommended to use G&G BB pellets only. Using low quality BB pellets will shorten product life and void product warranty.



Open the magazine top plate.



Pour G&G 5.95mm BBs into the chamber and close the plate when the chamber is full.



Turn the winding wheel on the bottom of the magazine to tighten the spring. This will allow the BBs to feed through the top of the magazine.



Insert the magazine into the airsoft gun until it clicks into place.



**RECOMMENDED BATTERY TYPE**  
**G-11-056**  
 NI-MH 9.6V 1600 mAh

### COMPONENTS

### HOP-UP ADJUSTMENT

#### ⚠ CAUTION

Do not catch your fingers in the dummy bolt. Never hold the gun sideways as the BB pellets will curve right or left.



Turn to **Normal** Turn to **Hop**

#### Too much Hop-up.

- ✗ ( Turn the adjustment dial toward **Normal** to correct the upward trajectory. )

Best Position.

- ✗ Not enough Hop-up. ( Turn the adjustment dial toward **Hop** to correct downward trajectory. )





# GC12 S.P.R.

## INSTRUCTION MANUAL



### ⚠ WARNING !!

- Adult supervision required.
- May be hazardous up to 50 meters.

- Stop shooting when the battery power is low.
- Do not adjust the motor without authorization or by certified technician.
- Always wear eye protection when using this product.
- Misuse or careless handling of this product may cause injury.

- This product is intended for users 18 years or older.
- Read all instructions before using this product.
- The buyer and the user of this product shall adhere to all local laws regulating the usage and the ownership of airsoft guns.

### RETRACTABLE STOCK



Press the stock release lever to unlock.



Adjust the position ( 6 position ).

### UNJAM



Remove the magazine.

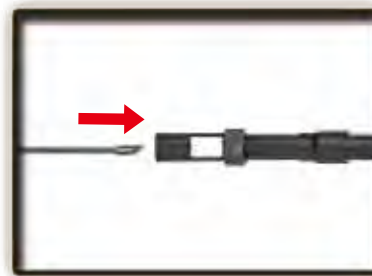

Return the hop up dial to normal position and insert the cleaning rod from the lead edge of the inner barrel.

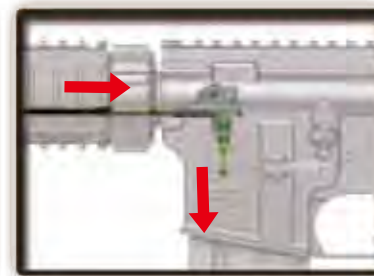

Be sure to have the rod facing down and reaching to the end to remove clogged pellets.

### TROUBLE SHOOTING



Set the selector lever to Semi or Full Auto.



Check the wire set contact on the motor.



Make sure the battery is fully charged and wires are properly connected.

### INSTALLING RAIL COVER



Press the metal spring to release the rail cover.

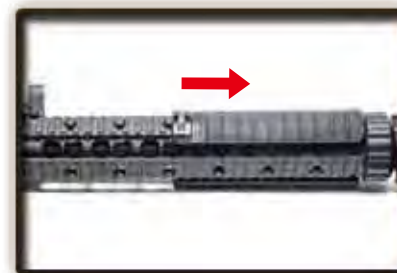

Slide to an appropriate position.

### REAR SIGHT ADJUSTMENT



**SMALL HOLE**  
Used for precision firing.



**LARGE HOLE**  
Used for full automatic firing.



**WINDAGE KNOB**  
(left / right adjustment)

### REAR SIGHT ADJUSTMENT



Press down the button to fold the rear sight.



Remove the screw by turning counterclockwise.



Pull the charging handle until the rear sight has been removed.

### PARTS LIST

GC12 SPR - 01	Flash Suppressor	GC12 SPR - 12	Buffer Tube Set
GC12 SPR - 02	Imitation Gas Tube	GC12 SPR - 13	Retractable Stock Set
GC12 SPR - 03	Outer Barrel Set	GC12 SPR - 14	Upper Receiver Set
GC12 SPR - 04	Delta Ring	GC12 SPR - 15	Inner Barrel
GC12 SPR - 05	Rail System Set	GC12 SPR - 16	Hop-Up Set
GC12 SPR - 06	Rail Cover	GC12 SPR - 17	Rear Sight
GC12 SPR - 07	450 Hi-Cap Magazine	GC12 SPR - 18	Battery Wire
GC12 SPR - 08	Grip Set	GC12 SPR - 19	Charging Handle Set
GC12 SPR - 09	Motor Set	GC12 SPR - 20	Gear Box Set
GC12 SPR - 10	Lower Receiver Set	GC12 SPR - 21	Front Sight
GC12 SPR - 11	Sling Swivel		

▶ The grouped parts may all be purchased from the G&G Support Department.

▶ E-Mail: [support@guay2com](mailto:support@guay2com)

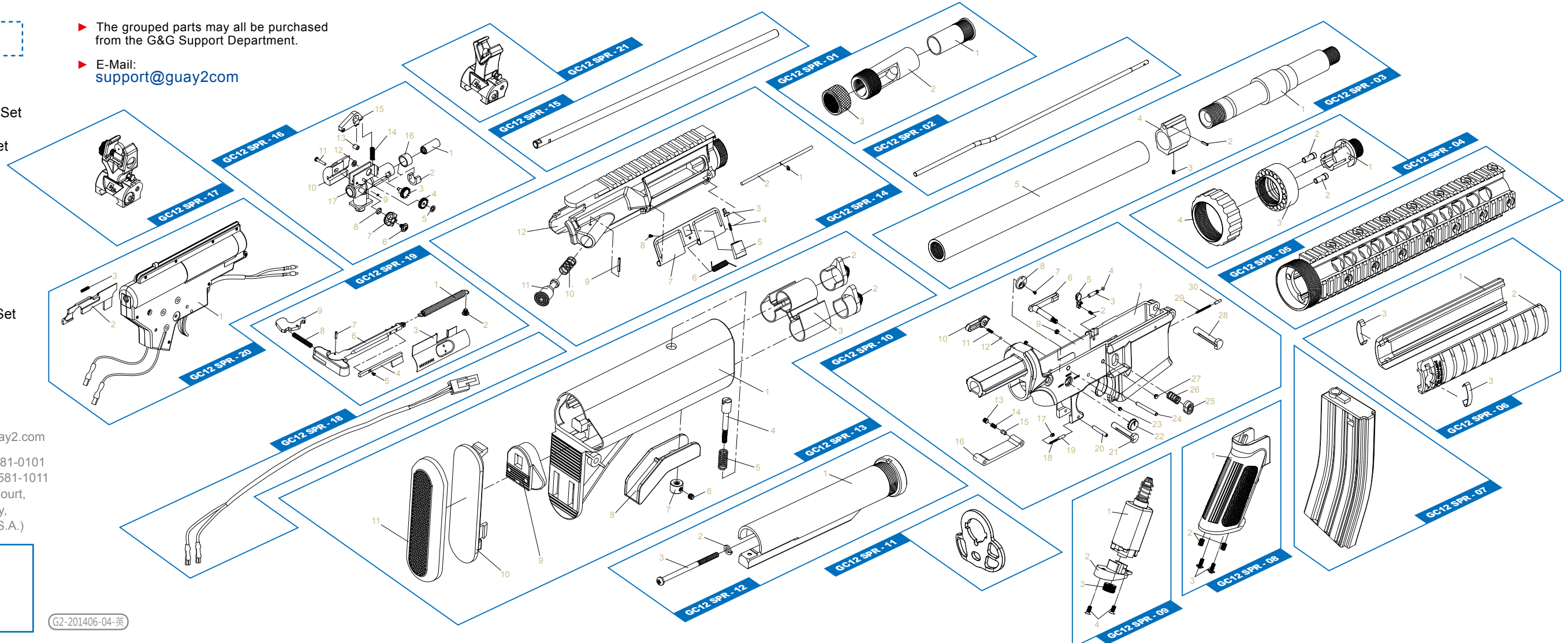

G2-201406-04-英

### TAIWAN

Sales Dept. | [sales@guay2.com](mailto:sales@guay2.com) , [b2b@guay2.com](mailto:b2b@guay2.com)  
Technology Support Dept. | [support@guay2.com](mailto:support@guay2.com)  
PR Dept. | [pr@guay2.com](mailto:pr@guay2.com)

Chang Hua Headquarter  
Tel : +886-4-798-9000 Fax : +886-4-798-9900  
No.999, Zhonghua Rd. Shengang Township,  
Changhua County 50955, Taiwan (R.O.C.)

Taipei  
Tel : +886-2-2692-2000 Fax : +886-2-2692-4000  
11F-3., No.27, Lane 169, Kangning St. Shijr City,  
Taipei County 22180, Taiwan (R.O.C.)

### U.S.A.

E-mail | [sales101@guay2.com](mailto:sales101@guay2.com)  
Tel : +1-626-581-0101  
Fax : +1-626-581-1011  
1122 Coiner Court,  
City of Industry,  
CA 91748 (U.S.A.)

### Dealer