



Q.D. Rail system

Front sight for GR16 C.Q.W.

Mock flash suppressor

Detachable rear sight

Charging handle

Selector lever

Retractable stock

Folding stock

Hi-cap 450R magazine

Trigger guard

Reinforced grip

# INSTRUCTION MANUAL

# GR4 100Y



All G&G products are complied with CE and ROHS 2.0. G&G Armament is also certified manufacturer of ISO 9001.

## COMPONENTS

### BATTERY SETTING

**Note:**  
 PLEASE READ THE BATTERY  
 INSTALLATION INSTRUCTIONS  
 BELOW BEFORE USE:

1. Please use Li-Po battery.
2. If nunchuck battery is used (very snug fit), please visit G&G's YouTube Channel (GGArment) for installation instructions.

### RECOMMENDED BATTERY TYPE

**G-11-041**  
 G-Power LI-PO 11.1V 20C  
 1100 mAh (Three-piece)

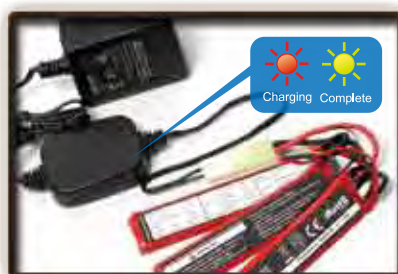

1. Charge up the battery.
2. Charging will be completed after 3 hours.



Release the plate lock.



Reinstall the Q.D. rail system.



Connect battery plug with the connector until you heard a click sound.



1. Insert battery into the Q.D. rail system.
2. Reinstall the Q.D. rail system and lock the plate lock.



**SAFETY ON**  
 The trigger cannot be pulled



**SEMI AUTO**  
 Single shot



**FULL AUTO**  
 Automatic firing

**CAUTION**

1. Please select quality battery with the CE approval, to avoid any unnecessary damage on the product.
2. Please use either 8.4V or 9.6V battery, if different voltage used, it might damage the product.
3. Remove the battery from the product when it is not in use.
4. Do not wet nor incinerate the battery, nor to deform the terminal.

### SETTING MAGAZINE

#### CAUTION

It is strongly recommended the use of G&G BB pellets only. Using low quality BB pellets will shorten product life span and void product warranty.



Open the cover of magazine.



Load G&G 5.95mm BB pellets into the magazine.



Close the cover plate then turn the gear until the sound changes.



Insert the magazine until you heard a click sound.

## FIRING MODE & SAFETY

#### CAUTION

Do not catch your fingers in the dummy bolt. Never hold the gun sideways as the BB pellets will curve right or left.



## HOP-UP ADJUSTMENT

- Too much Hop-up. (Turn the adjust lever toward Normal)
- Best Position.
- Not enough Hop-up. (Turn the adjust lever toward Hop) or Too much Hop-up. (Turn the adjust lever toward Normal)



## New Blow Back Pneumatic System

True to the faith of mimicking real life firearms, G&G is proud to present its new Pneumatic Blow Back system to its line of airsoft guns. Conventional airsoft blow back utilizes tow hook springs to mimic real life bolt actions, which often lead to excess wear and tear and poor reliability in the gear box. To alleviate the problem of conventional systems, G&G has independently developed the Pneumatic Blow Back system; a piston driven, gas operated mechanism to better mimic real life bolt actions. This new technology utilizes compressed air to move the bolt, which enables the action without adding extra stress to the gear box. This class leading system represents a significant milestone in the airsoft industry.

	<b>TAIWAN</b> Patent No : M300797		<b>EUROPEAN UNION</b> Patent No : 460191 814454
	<b>USA</b> Patent No : 11/488698		<b>CHINA</b> Patent No : 200620122468.9
	<b>HONG KONG</b> Patent No : 06107627.0		<b>DENMARK</b> Patent No : BA2007 0069
	<b>JAPAN</b> Patent No : 實 願 2006-1459		<b>U.K.</b> Patent No : 614422.4

**WARNING !!**

- Adult supervision required.
- Always wear eye protection when using this product.
- Misuse or careless handling of this product may cause injury.
- May be hazardous up to 50 meters.
- This product is intended for users 18 years or older.
- Read all instructions before using this product.
- The buyer and the user of this product shall adhere to all local laws regulating the usage and the ownership of airsoft guns.



# INSTRUCTION MANUAL

# GR4 100Y



**TOP FIVE**  
 FUTURE INNOVATION  
 BEST QUALITY  
 FAST SERVICE  
 FREE ITEMS  
 AIR PRICE



**SPECIAL SHOOTING**  
 Used for precision firing.



**COMMON SHOOTING**  
 Used for full automatic firing.



**WINDAGE KNOB** (left / right adjustment)  
**ELEVATION KNOB** (up / down adjustment)

## REAR SIGHT ADJUSTMENT

**CAUTION**  
 Keep the selector on Safe mode until you are actually ready to shoot.

## RETRACTABLE STOCK

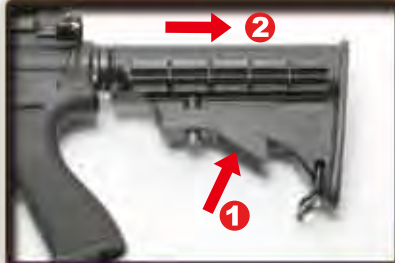

Press the stock release lever to unlock.



Adjust the position ( 6 position ).

## WINDAGE ADJUSTMENT KNOB



Detachable rear sight.



Turn the knobs counterclockwise to disassemble the rear sight.



Take off the rear sight to install other accessories.

## MAINTENANCE



Remove the magazine.

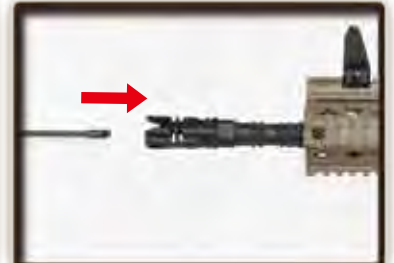

Return the hop up dial to normal position and insert the cleaning rod from the lead edge of the inner barrel.

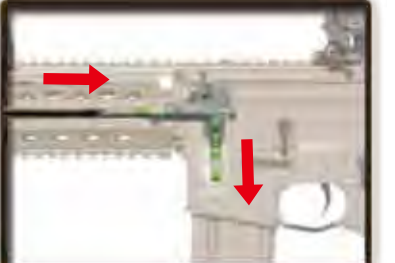

Be aware to have the rod facing down and reaching to the end, and remove clogged pellets.

## OPTIONAL PARTS



**G-12-006**  
 CD13-TRT30GD Red-Dot Scope



**G-03-105**  
 SCAR BIPOD GRIP

## FOLDING THE STOCK

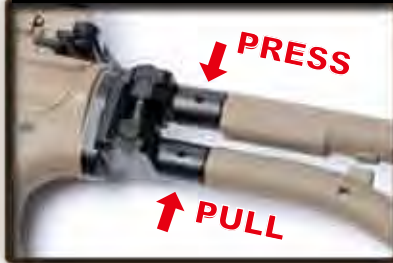

Press and Pull the stock to unlock.



Folding the stock.



Turn the folding stock to be locked.

## TROUBLE SHOOTING



Adjust screw when the gear noise becomes shrilly.

The screw at bottom of the grip. Please use the screwdriver to adjust.



No operation

Check the wire set contact with motor.



No operation

Check the battery and connector.

## PARTS LIST

- |                     |                          |                     |                            |
|---------------------|--------------------------|---------------------|----------------------------|
| <b>GR4 100Y- 01</b> | Flash suppressor set     | <b>GR4 100Y- 18</b> | Lower receiver set         |
| <b>GR4 100Y- 02</b> | Rail system set          | <b>GR4 100Y- 19</b> | Trigger guard set          |
| <b>GR4 100Y- 03</b> | Rear sight base set      | <b>GR4 100Y- 20</b> | Selector plate             |
| <b>GR4 100Y- 04</b> | Rear sight set           | <b>GR4 100Y- 21</b> | Rear frame lock pin set    |
| <b>GR4 100Y- 05</b> | Hop-up set               | <b>GR4 100Y- 22</b> | Grip                       |
| <b>GR4 100Y- 06</b> | Upper receiver rail set  | <b>GR4 100Y- 23</b> | Motor set                  |
| <b>GR4 100Y- 07</b> | Inner barrel             | <b>GR4 100Y- 24</b> | Grip bottom set            |
| <b>GR4 100Y- 08</b> | Upper receiver set       | <b>GR4 100Y- 25</b> | Extended stock set         |
| <b>GR4 100Y- 09</b> | Charging handle set      | <b>GR4 100Y- 26</b> | Gear box set               |
| <b>GR4 100Y- 10</b> | Port cover set           | <b>GR4 100Y- 27</b> | Barrel base set            |
| <b>GR4 100Y- 11</b> | Front frame lock pin set | <b>GR4 100Y- 28</b> | Blow back pneumatic piston |
| <b>GR4 100Y- 12</b> | Bolt catch set           | <b>GR4 100Y- 29</b> | Charging plate             |
| <b>GR4 100Y- 13</b> | Selector lever set       | <b>GR4 100Y- 30</b> | Charging upper cover       |
| <b>GR4 100Y- 14</b> | Magazine catch set       | <b>GR4 100Y- 31</b> | Switch plate               |
| <b>GR4 100Y- 15</b> | Stock washer             | <b>GR4 100Y- 32</b> | Folding stock set          |
| <b>GR4 100Y- 16</b> | Enhanced rod set         | <b>GR4 100Y- 33</b> | Front sight set            |
| <b>GR4 100Y- 17</b> | Hi-cap 450R magazine     | <b>GR4 100Y- 34</b> | Folding stock base set     |

## MANUFACTURED BY G&G ARMAMENT

### TAIWAN

Sales Dept. | sales@guay2.com , b2b@guay2.com  
 Technology Support Dept. | support@guay2.com  
 PR Dept. | pr@guay2.com

**Chang Hua** Headquarter  
 Tel : +886-4-798-9000 Fax : +886-4-798-9900  
 No.999, Zhonghua Rd. Shengang Township,  
 Changhua County 50955, Taiwan (R.O.C.)

**Taipei**  
 Tel : +886-2-2692-2000 Fax : +886-2-2692-4000  
 11F-3., No.27, Lane 169, Kangning St. Shijr City,  
 Taipei County 22180, Taiwan (R.O.C.)

### U.S.A.

E-mail | sales101@guay2.com

**Los Angeles**  
 Tel : +1-626-581-0101  
 Fax : +1-626-581-1011  
 1122 Coiner Court,  
 City of Industry,  
 CA 91748 (U.S.A.)

Dealer

G2-201401-08-英

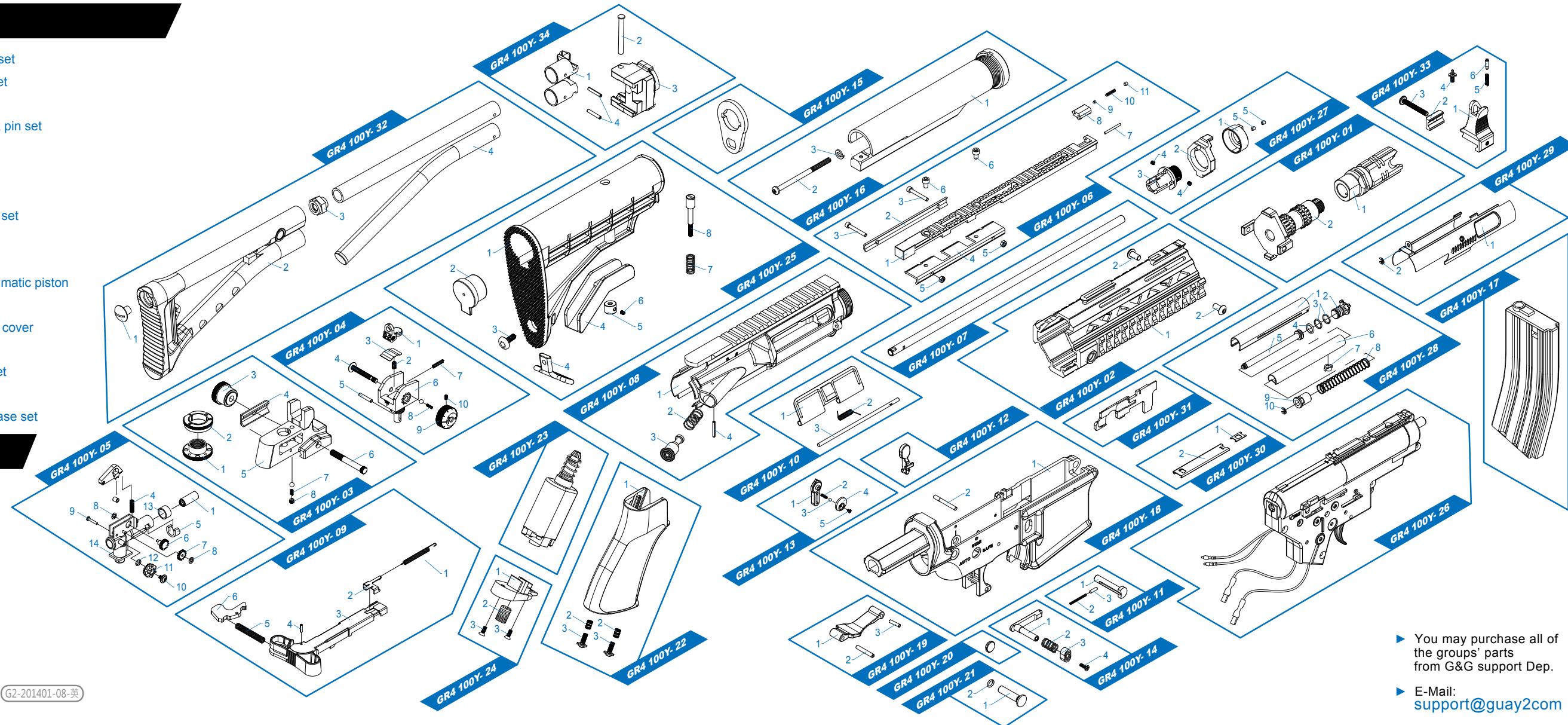

▶ You may purchase all of the groups' parts from G&G support Dep.  
 ▶ E-Mail: support@guay2com